

SUZUKI GSX-S1000 / GSX-S1000GT / GSX-S950 / KATANA EEC SLIP-ON R-77S

Be sure to read the instruction carefully before starting the work. It is necessary to follow the contents to install Yoshimura product.

Product information



- CAUTION** Before beginning installation, let motorcycle cool down.
- CAUTION** Be sure not to damage each part during installation.
- CAUTION** Torque specification must be followed. If neglected, it may cause bolt and nut to fall off and damage to Yoshimura product and motorcycle.
- CAUTION** Metal Magic sleeve is coated with heat-resistant paint. Handle with care not to be hit or scratched by surroundings as the coating may come off. When cleaning silencer, use soft cloth with dish soap but do not use metal polish or chemical cleaner.
- CAUTION** Titanium Blue sleeve is colored by anodizing. Handle with care as the color may change. When cleaning silencer, use soft cloth with dish soap but do not use metal polish or chemical cleaner.

1. Product Information :

Description	SUZUKI GSX-S1000 / GSX-S1000GT / GSX-S950 / KATANA EEC Slip-On R-77S		
Cyclone Type	S19ES77C1	Main Material	Stainless steel
Part Number	Metal Magic Sleeve (SM) : 1F0-19E-5W20	EEC Approval No.	e1 00085G
	Satin Finish Sleeve (SSF) : 1F0-19E-5W30	Weight (SSF) & (SM)	: 2.3 kg
	Titanium Blue Sleeve (STB) : 1F0-19E-5W80B	Weight [STD : 2.3kg] (STB)	: 2.1 kg

2. Applicable Model :

Model	SUZUKI GSX-S1000(21-24) / GSX-S1000GT(22-24) / GSX-S950(22) / KATANA (22-24)
-------	--

3. Contents:

No.	Descriptions	Part No.	Q'ty	No.	Descriptions	Part No.	Q'ty
1	Silencer Assy, (SM)	1F6-19E-5W20	1	5	Button Bolt M6x15	803-206-4015	2
	Silencer Assy, (SSF)	1F6-19E-5W30		6	Washer M6x13	812-206-1310	2
	Silencer Assy, (STB)	1F6-19E-5W80B		7	Flange Nut M6	823-006-1000	2
2	Silencer Band	162-22R-G500	1	8	Heat Guard	161-19E-0010	1
3	Silencer Band Rubber	896-016-0835	1	9	Button Bolt M6x12	803-206-4012	1
4	Silencer Bracket	161-19E-0000	1	10	Conical Spring Washer M6	810-206-0000	1

Parts Diagram

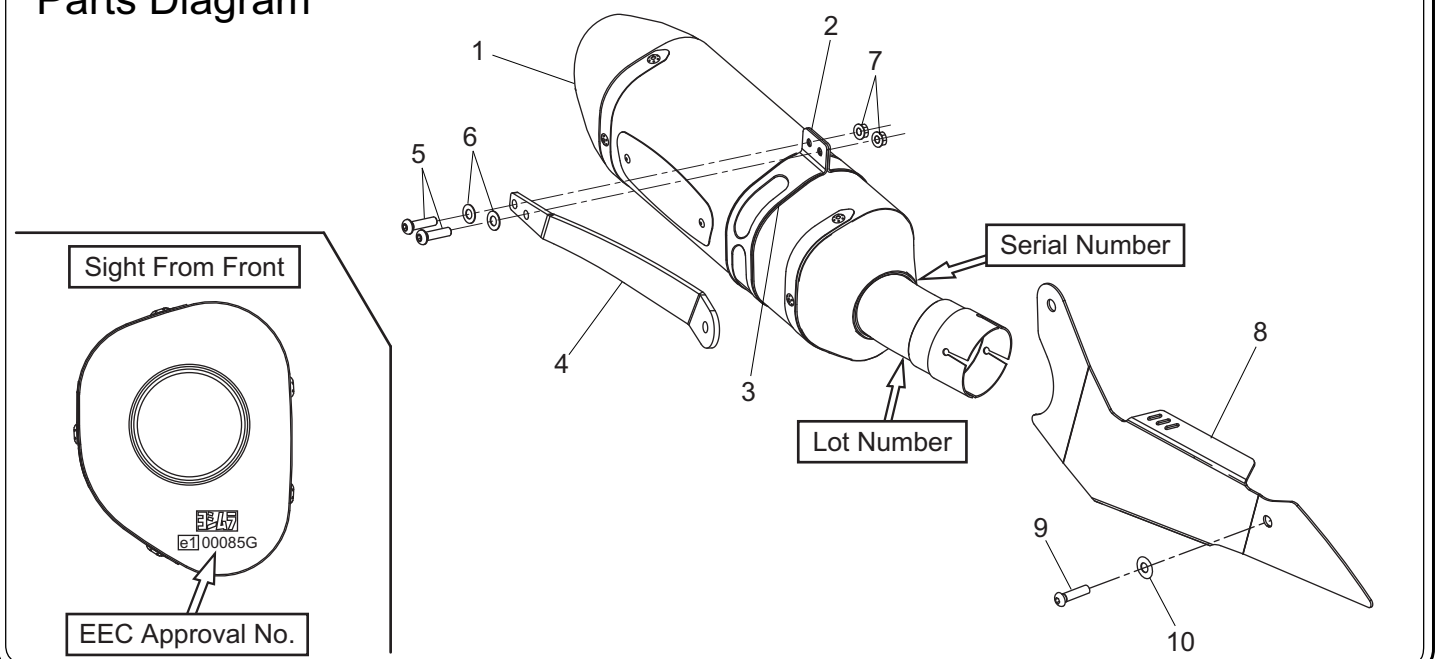

4. Installation steps:

- 1) Check that all the component parts are in hand.
- 2) According to SUZUKI service manual, remove stock silencer assembly (See Fig. 1).

CAUTION When removing stock silencer assembly, be careful not to damage swing arm or other components.

REFERENCE Stock bolt, washer and nut removed at this stage are reused when mounting Heat Guard.

- 3) Remove stock clamp band from silencer assembly removed at step 2).

REFERENCE Stock clamp band removed at this stage is reused when mounting Yoshimura slip-on.

- 4) Insert SUZUKI genuine gasket into front end of Silencer Assy and mount stock clamp band removed at step 3) (See Fig. 2).

CAUTION Use SUZUKI genuine new exhaust gasket.

- 5) Install Silencer Assy to stock tailpipe (See Fig. 3). Tighten the bolt on stock clamp band by hand only at this stage.

- 6) Take off stock grommet spacer which is mounted from vehicle side and remount it from outside (See Fig. 5).

- 7) Mount Heat Guard and Silencer Bracket with Button Bolt M6x12, Conical Spring Washer M6, stock bolt, washer and nut removed at step 2) (See Fig. 4 & 5). Tighten bolts by hand only at this stage.

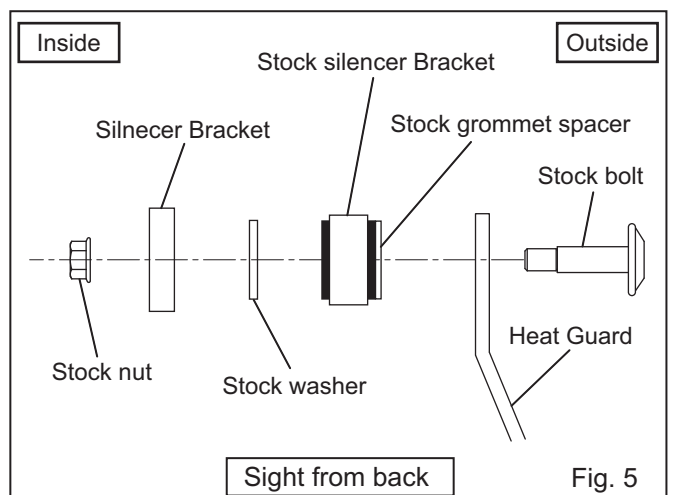
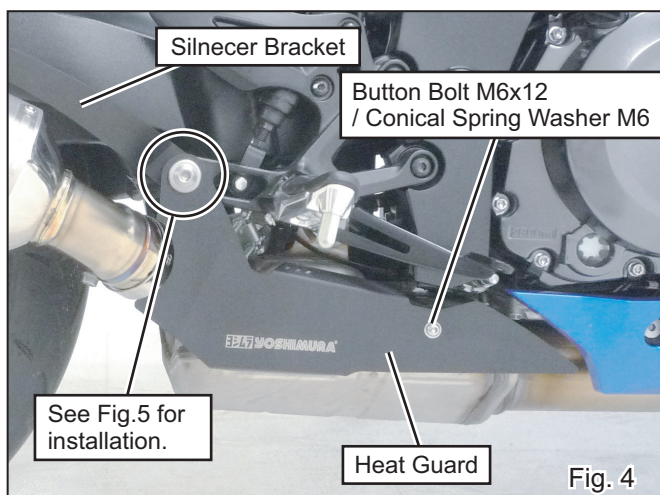
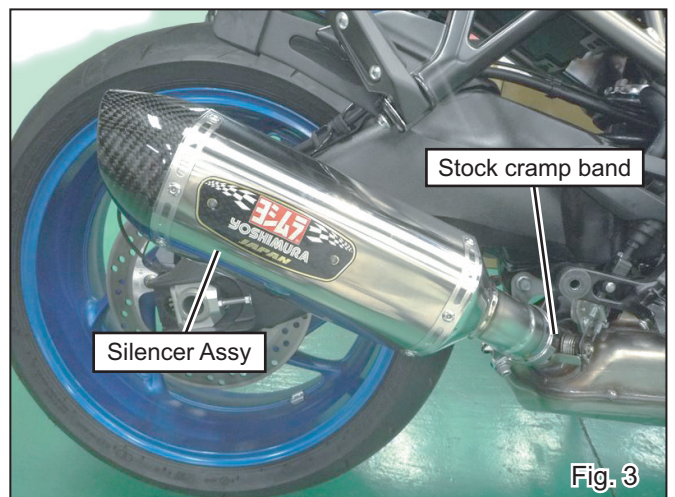
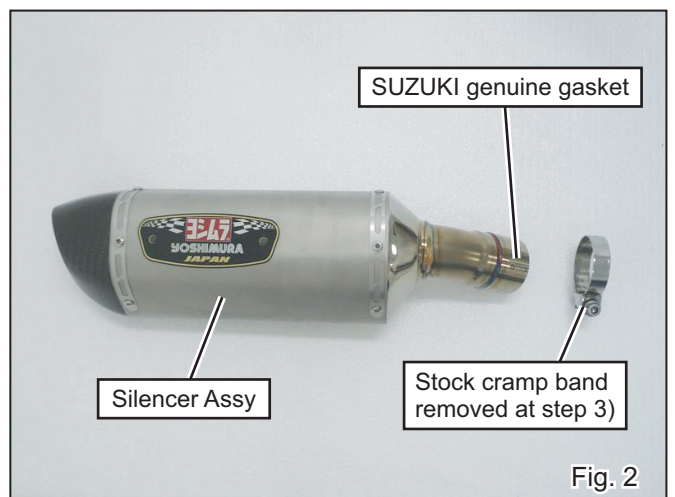

- 8) Place Silencer Band Rubber inside Silencer Band, and put the Silencer Band on Silencer Assy. Then, mount Silencer Bracket onto the Silencer Band with 2 of each Button Bolt M6x15, Washer M6 and Flange Nut M6 (See Fig. 6 & 7). Tighten the bolt by hand only at this stage.

REFERENCE Cut excess of Silencer Band Rubber with scissors etc. when placing it inside Silencer Band.

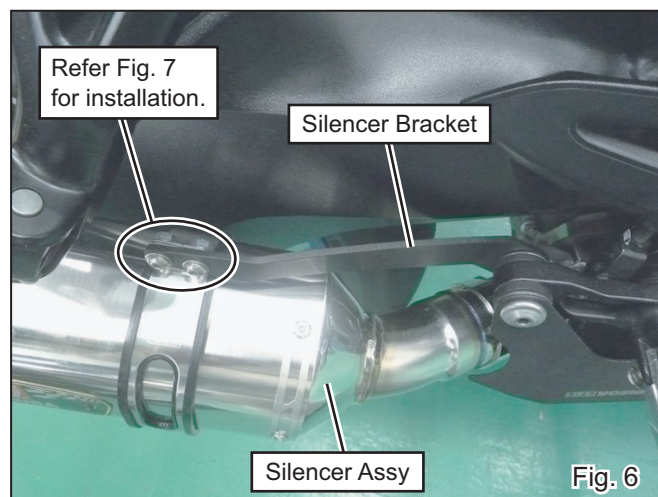
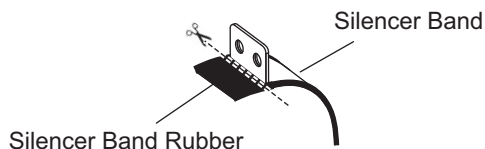

Fig. 6

CAUTION Be sure to place Silencer Band at right angles to Silencer Assy. If neglected, it may cause breakage to Silencer Band.

CAUTION Before hand-tighten Silencer Band, make sure silencer sleeve and Silencer Band fit evenly and there is no opening between them. If neglected, it may cause deformation of silencer sleeve.

- 9) Check that there are proper clearances between Yoshimura slip-on and other components. Then, tighten and torque stock clamp band, stock bolt on Heat Guard, 2 of Button Bolt M6x20 and Button Bolt M6x12 in order (See Fig. 8 & 9).

Tightening Torque	Stock clamp band	: 18Nm
	Stock bolt	: 23Nm
	Button Bolt M6x15	: 10Nm
	Button Bolt M6x12	: 10Nm

CAUTION Torque specification must be followed.

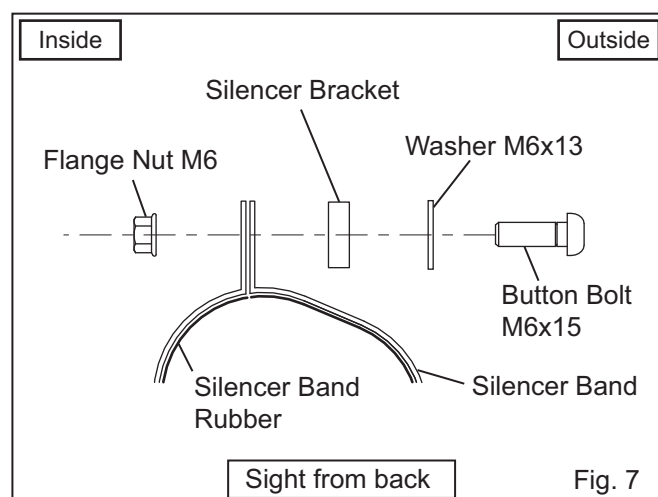

Fig. 7



Fig. 8

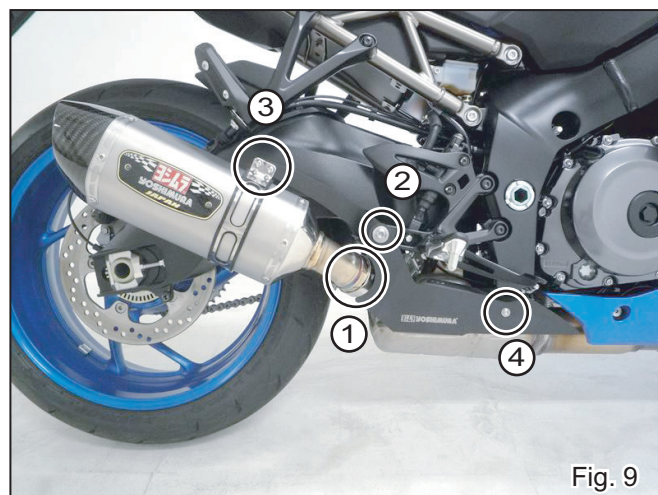

Fig. 9

- 10) It is recommended that whole Yoshimura slip-on to be wiped down with dish soap to remove oil and finger prints. This will prevent tarnishing of finish after slip-on heats up.

CAUTION

When cleaning silencer, use soft cloth with dish soap. Do not use metal polish or parts cleaner. If neglect, the paint of Emblem and Metal Magic finish may come off or Titanium Blue color may tarnish.

- 11) It is recommended that whole Yoshimura slip-on to be wiped down with dish soap to remove oil and finger prints. This will prevent tarnishing of finish after slip-on heats up.

! CAUTION

Before beginning the work, let motorcycle cool down.

REFERENCE

It is normal for new silencer to smoke until inside oil residue burns off.

After Installation



After Installation



! CAUTION

Titanium Blue sleeve is colored by anodizing. Handle with care as the color may change. When cleaning silencer, use soft cloth with dish soap but do not use metal polish or chemical cleaner.

! CAUTION

This exhaust is produced for street use only. In case that it is used on race circuit or tested on chassis dynamometer, any damage or carbon discoloration is not included in warranty.

REFERENCE

Yoshimura Japan recommends silencer inner wool replacement every 5,000km (3,000miles) in order to get Yoshimura exhaust performance fully. Climate, riding condition, and frequency of ride are direct contributing factors for inner wool worn out. Keeping high engine revolution also promotes further wool consumption. For silencer repairing, please contact local Yoshimura distributor for further information.

- CAUTIONS AFTER INSTALLATION -

- ⦿ Check each bolt sometimes to see that there is no failure condition such as poor tightening.
- ⦿ Quality control is implemented on all products. If, however, any defect or failure is found, please notify Yoshimura Japan through the selling dealer. Necessary technical service or replacing of the product will be made.
- ⦿ Due to improvement, the specifications and price of the product are subject to change without notice.
- ⦿ For any information regarding this product, please address inquiries to Yoshimura Japan Co., Ltd.

Yoshimura Japan Co., Ltd.

6748 Nakatsu, Aikawa, Aiko, Kanagawa 243-0303 Japan

Web site: <http://www.yoshimura-jp.com> E-Mail: yj-world@yoshimura-jp.com