

HONDA FORZA250/350/ADV350 Street Sport Full System R-77J

Be sure to read the instruction carefully before starting the work. It is necessary to follow the contents to install Yoshimura product.

Product information



- CAUTION** Before beginning installation, let motorcycle cool down.
- CAUTION** Be sure not to damage each part during installation.
- CAUTION** Torque specification must be followed. If neglected, it may cause bolt and nut to fall off and damage to Yoshimura product and motorcycle.
- CAUTION** Metal Magic sleeve is coated with heat-resistant paint. Handle with care not to be hit or scratched by surroundings as the coating may come off. When cleaning silencer, use soft cloth with dish soap but do not use metal polish or chemical cleaner.
- CAUTION** Titanium Blue sleeve is colored by anodizing. Handle with care as the color may change. When cleaning silencer, use soft cloth with dish soap but do not use metal polish or chemical cleaner.

1. Product Information :

Description	HONDA FORZA250/350/ADV350 Street Sport Full System R-77J		Cyclone Type	H45FS77C1
Part Number	Metal Magic Sleeve (SM)	: 180A-45F-5120	Main Material	Stainless steel
	Stainless Sleeve (SSF)	: 180A-45F-5130	Weight	(SM) & (SSF) : 3.7kg
	Titanium Blue Sleeve (STB)	: 180A-45F-5180B	[STD : 6.7kg]	(STB) : 3.5kg

2. Applicable Model :

Model	HONDA FORZA250/350('21) / ADV350('22)
-------	---------------------------------------

3. Contents:

No.	Descriptions	Part No.	Q'ty	No.	Descriptions	Part No.	Q'ty
1	Exhaust Pipe	181-45F-5100	1	8	Button Bolt M6x15	803-206-4015	2
2	Silencer Assy Metal Magic Sleeve	186-45F-5120	1	9	Button Bolt M6x20	803-206-4020	2
	Silencer Assy Stainless Sleeve	186-45F-5130		10	Washer M10x22	812-110-2216	2
	Silencer Assy Titanium Blue Sleeve	186-45F-5180B		11	Washer M6x13	812-206-1310	4
3	Silencer Band	162-38R-H500	1	12	Flange Nut M6	823-006-1000	4
4	Silencer Band Rubber	896-016-0835	1	13	ExhaustSpring(MediumFloating)	118-001-2000	1
5	Silencer Bracket (Upper)	161-45F-0300	1	14	dB Killer SD#98	138-138-4398	1
6	Silencer Bracket (Lower)	161-45F-0310	1	15	Cap Bolt M6x6 Thread Lock	800-806-4006	1
7	Cap Bolt M10x35 P1.25	800-210-5035	2				

Parts Diagram

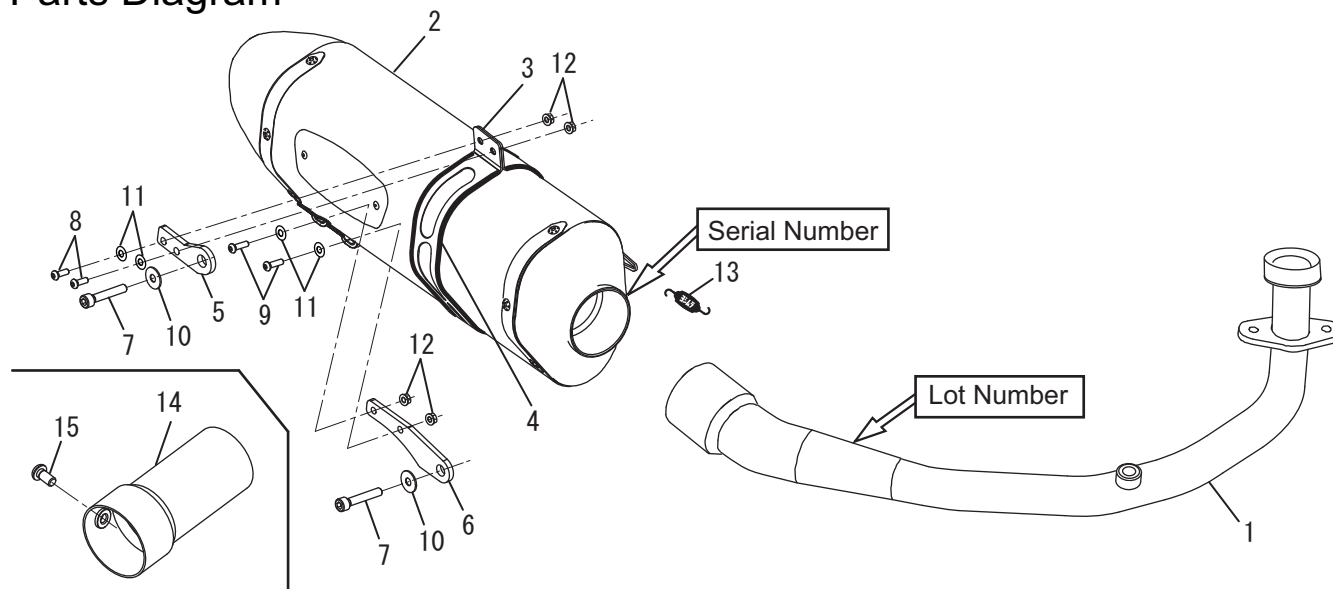

4. Installation steps:

- 1) Check that all the component parts are in hand.
- 2) According to HONDA Service Manual, remove the exhaust pipe protector.
- 3) Keep motorcycle straight up with main stand. Disconnect O2 sensor coupler and remove stock exhaust system from vehicle. (See Fig. 1)

CAUTION When removing exhaust system, be careful not to damage frame or other components.

REFERENCE Stock nuts removed at this stage are reused when mounting Yoshimura product.

- 4) According to Honda Service Manual, remove ignition coil cover, take off the tape which ties O2 sensor wire and release O2 sensor coupler from the bracket. (See Fig. 2)
- 5) Remove O2 sensor from stock exhaust system and install it on Exhaust Pipe. Tighten and torque the O2 sensor. (See Fig. 3)

CAUTION Handle O2 sensor with care not to be hit. If neglected, it may cause serious damage.

Tightening Torque O2 sensor : 25Nm

- 6) Make sure to insert HONDA genuine exhaust gasket into exhaust port. Then, mount Exhaust Pipe on exhaust port with stock nuts. Tighten nuts by hand at this stage. (See Fig. 4 & 5)

CAUTION Use HONDA genuine new gasket.



Fig. 1

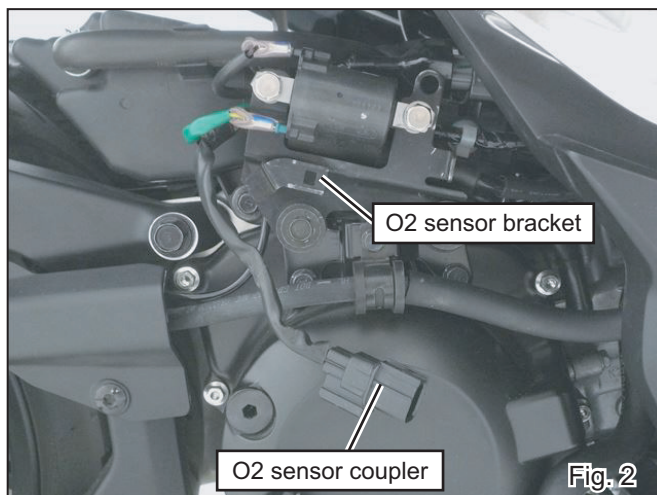

Fig. 2

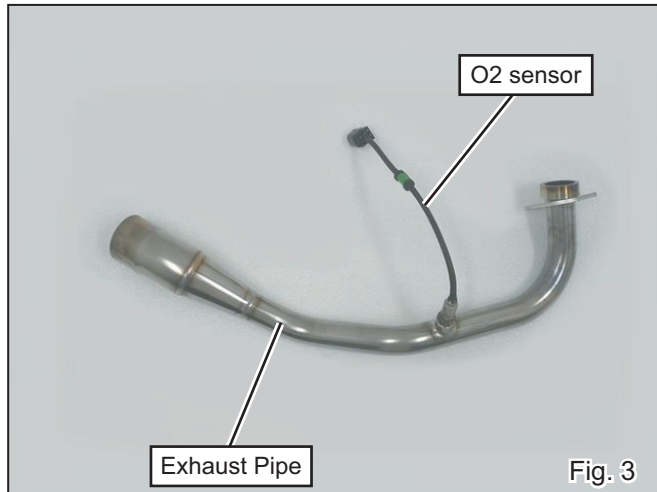

Fig. 3

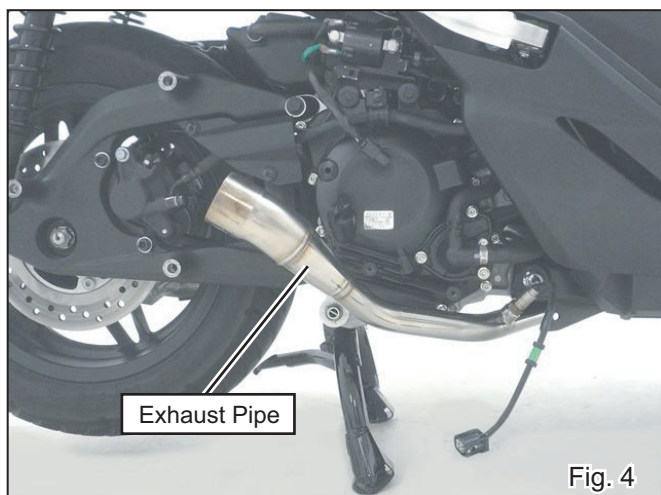

Fig. 4

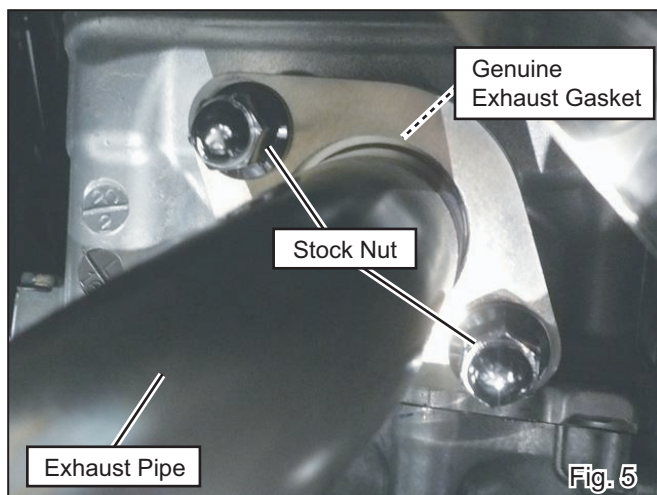
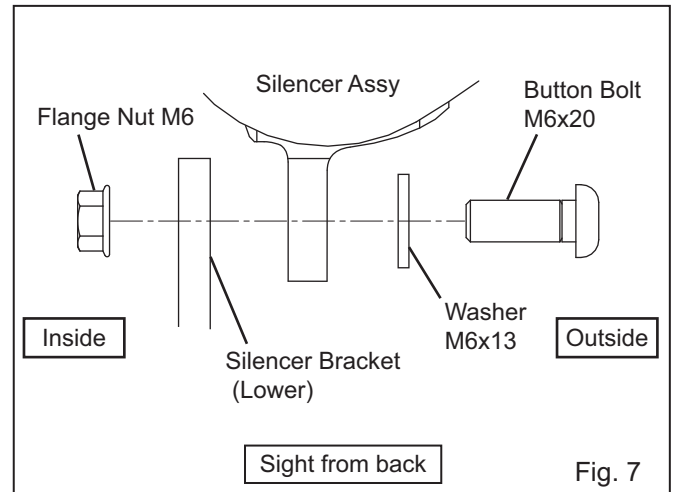
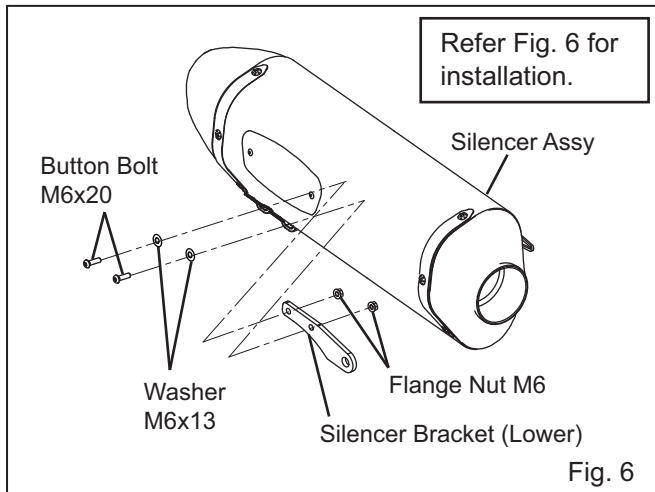

Fig. 5

- 7) Attach Silencer Bracket (Lower) onto Silencer Assy with 2 of each Button Bolt M6x20, Washer M6x13 and Flange Nut M6. (See Fig. 6 & 7) Tighten bolts by hand only at this stage.



- 8) Place Silencer Band Rubber inside Silencer Band, and slide them on Silencer Assy. Then, Set Silencer Band position at **115mm** from front edge of silencer sleeve, then fix Silencer Band on Silencer Bracket (Upper) with 2 of each Button Bolt M6x15, Washer M6x13 and Flange Nut M6. (See Fig. 8 & 9) Tighten bolts by hand only at this stage.

CAUTION Be sure to place Silencer Band at right angles to Silencer Assy. If neglected, it may cause breakage to Silencer Band.

CAUTION Before tighten Silencer Band, make sure silencer sleeve and Silencer Band fit evenly and there is no opening between them. If neglected, it may cause deformation of silencer sleeve.

REFERENCE Cut excess of Silencer Band Rubber with scissors etc. when placing it inside Silencer Band.

CAUTION Be sure to place Silencer Band at right angles to Silencer Assy. If neglected, it may cause breakage to Silencer Band.

CAUTION Before hand-tighten Silencer Band, make sure silencer sleeve and Silencer Band fit evenly and there is no opening between them. If neglected, it may cause deformation of silencer sleeve.

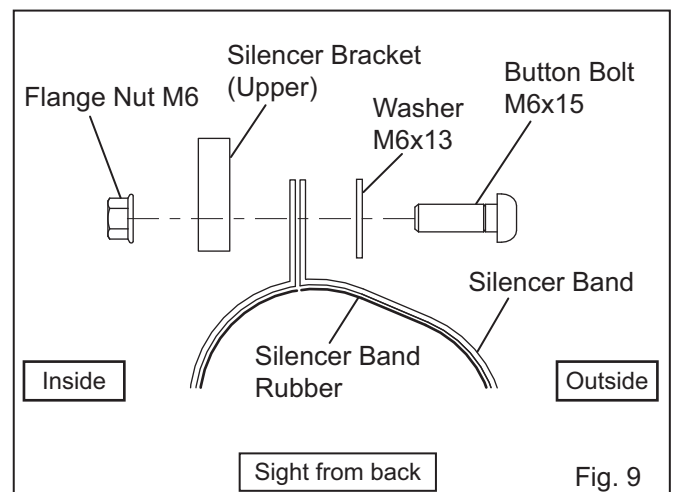
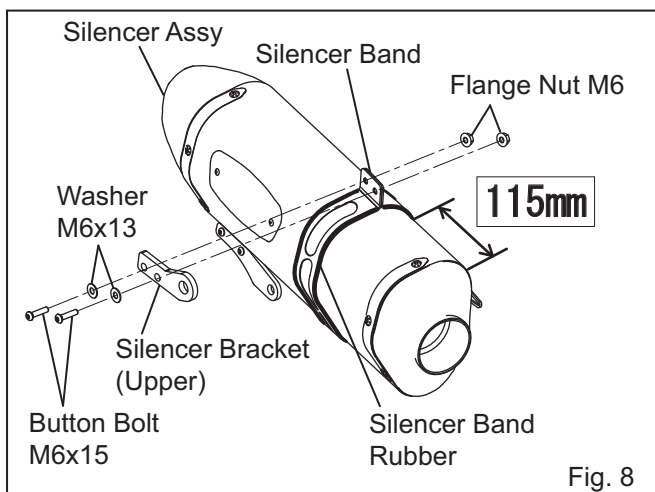
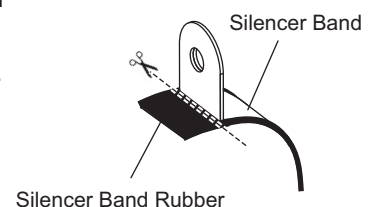

- 9) If necessary, install dB Killer SD#98 using Cap Bolt M6x6 Thread Lock. (See Fig. 10) Tighten and torque the bolt.

Tightening Torque Cap Bolt M6x6 Thread Lock : 10 Nm

CAUTION Torque specification must be followed.

REFERENCE

Without dB Killer	; 94.2dB / 3,875rpm
dB Killer SD#98	; 93.1dB / 3,875rpm

- 10) Mount Silencer Assy on Exhaust Pipe and fix Silencer Bracket (Lower) with Cap Bolt M10x35 P1.25 and Washer M10x22. Tighten bolt by hand only at this stage. Then install Exhaust Spring. (See Fig. 11, 12 & 13)

CAUTION Make sure that exhaust spring is hooked to installing tool firmly. If neglected, it may cause injury.

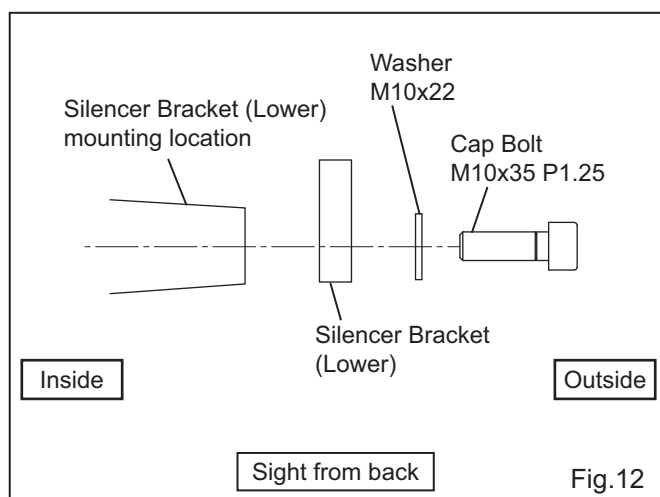

Fig.12

- 11) Mount Silencer Bracket (Upper) with Cap Bolt M10x35 P1.25 and Washer M10x22. Tighten bolt by hand only at this stage. (See Fig. 11 & 14)

- 12) Check from back, adjust the position and angle of Silencer Assy and keep proper clearance between Yoshimura exhaust system and other components such as swing arm. Then, tighten and torque 2 of stock nut at exhaust port, Cap Bolt M8 on Exhaust Pipe Bracket, and Cap Bolt M10 and Cap Bolt M6 on Silencer Bracket in order. (See Fig.15 & 16 on next page)

Tightening Torque

Stock Nuts	: 15 Nm
Cap Bolt M10	: 28 Nm
Button Bolt M6	: 10 Nm

CAUTION Torque specification must be followed.

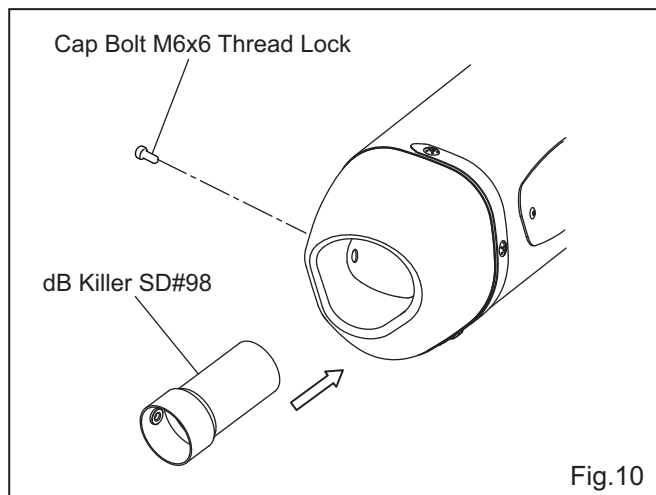

Fig.10

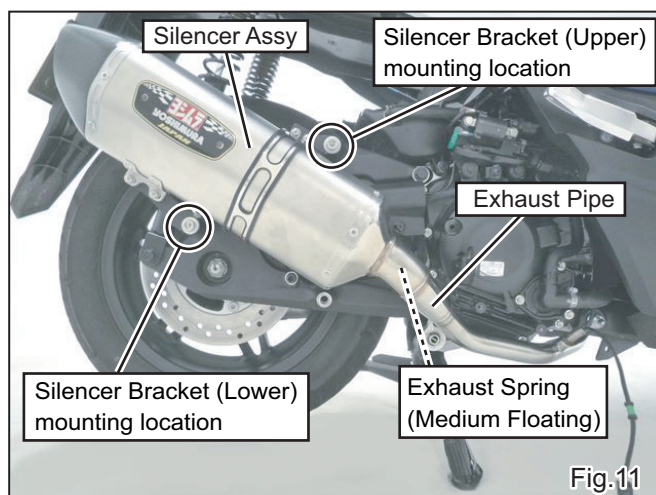

Fig.11

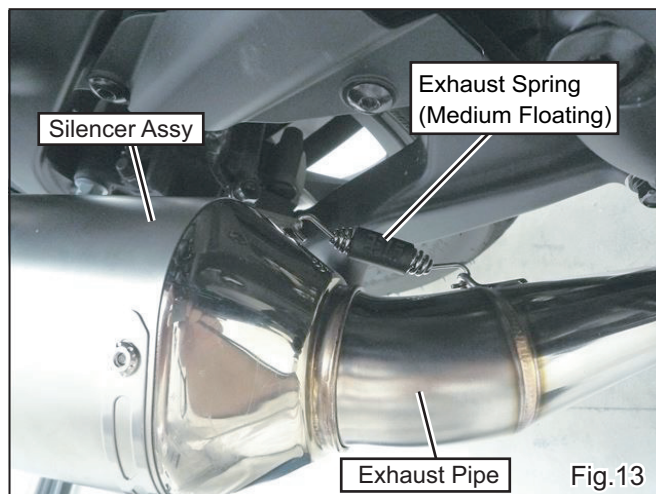

Fig.13

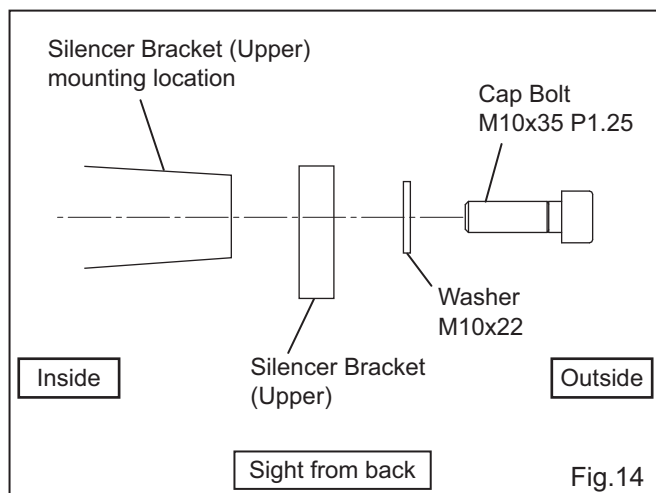

Fig.14

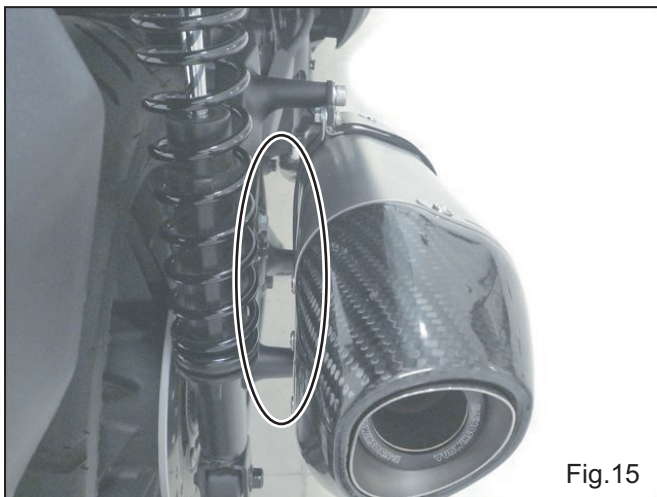

Fig.15



Fig.16

- 13) Locate O2 sensor wire as shown in Fig. 17 & 18, fix the wire with Stock harness clamp and reconnect coupler on vehicle. Then reattach ignition coil cover which was removed at Step 4). (See Fig. 19)

! CAUTION Be careful not to damage O2 sensor. If neglected, it may cause serious damage.

! CAUTION Do not pull or give tension to the wire to avoid any damage or break in the cable.

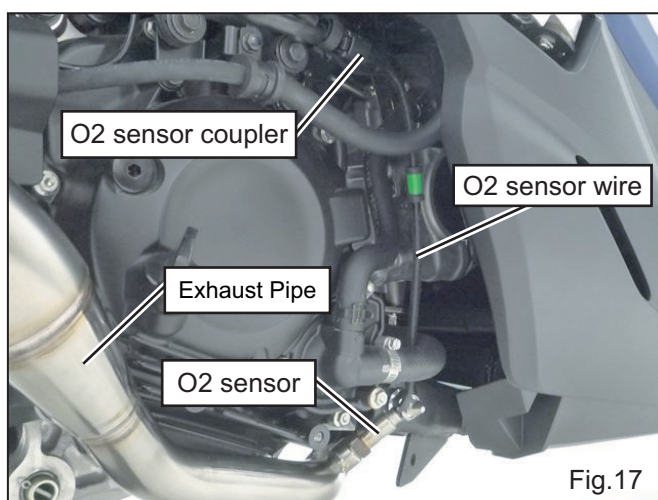

Fig.17

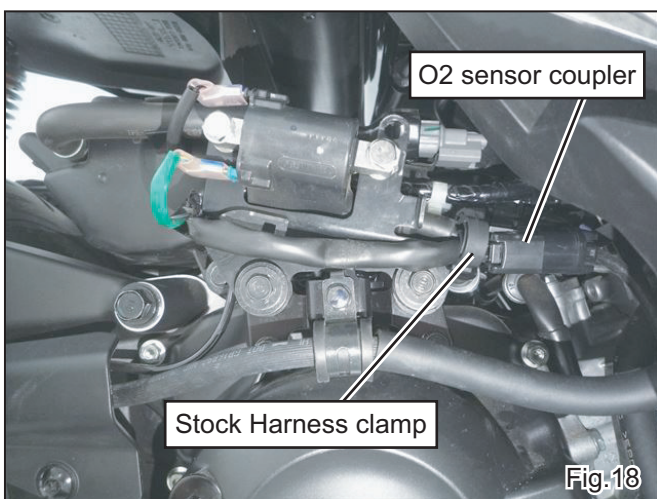

Fig.18



Fig.19

- 14) It is recommended whole Exhaust System to be wiped down with dish soap to remove oil and fingerprints. This will prevent from tarnishing of finish after Exhaust System has heated up.

! CAUTION When cleaning silencer, use soft cloth and do not use metal polish or parts cleaner. If neglect, the paint of Emblem and Metal Magic finish may come off or Titanium Blue color may tarnish.

15) Remount exhaust pipe protector which was removed at Step 2). (See Fig.20)

16) Warm-up engine, and inspect the exhaust leaking. If "after fire" sounds severely, seal the gaps of joint with silicone gasket etc. Then, tighten all bolts further after engine has cooled down. If any problem is found, please follow through instruction steps carefully again.

REFERENCE It is normal for new silencer to smoke until inside oil residue burns off.

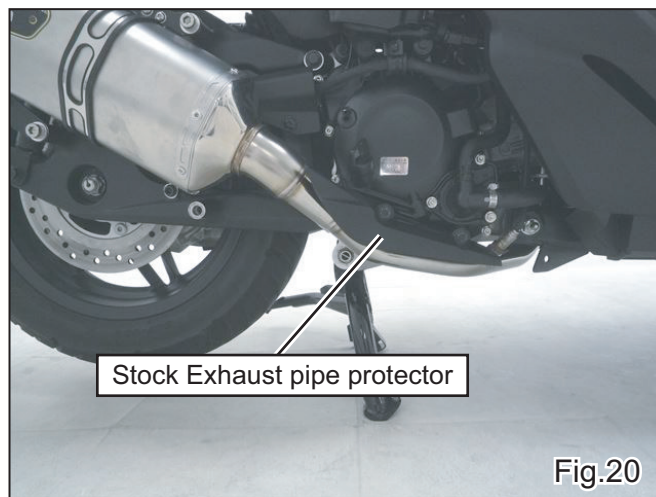

After Installation



! CAUTION

Metal Magic sleeve is coated with heat-resistant paint. Handle with care not to be hit or scratched by surroundings as the coating may come off. When cleaning silencer, use soft cloth with dish soap but do not use metal polish or chemical cleaner.

! CAUTION

Titanium Blue sleeve is colored by anodizing. Handle with care as the color may change. When cleaning silencer, use soft cloth with dish soap but do not use metal polish or chemical cleaner.

! CAUTION

This exhaust is produced for street use only. In case that it is used on race circuit or tested on chassis dynamometer, any damage or carbon discoloration is not included in warranty.

REFERENCE

Yoshimura Japan recommends silencer inner wool replacement every 5,000km (3,000miles) in order to get Yoshimura exhaust performance fully. Climate, riding condition, and frequency of ride are direct contributing factors for inner wool worn out. Keeping high engine revolution also promotes further wool consumption. For silencer repairing, please contact local Yoshimura distributor for further information.

- CAUTIONS AFTER INSTALLATION -

- ⊙ Check each bolt sometimes to see that there is no failure condition such as poor tightening.
- ⊙ Quality control is implemented on all products. If, however, any defect or failure is found, please notify Yoshimura Japan through the selling dealer. Necessary technical service or replacing of the product will be made.
- ⊙ Due to improvement, the specifications and price of the product are subject to change without notice.
- ⊙ For any information regarding this product, please address inquiries to Yoshimura Japan Co., Ltd.

Yoshimura Japan Co., Ltd.

6748 Nakatsu, Aikawa, Aiko, Kanagawa 243-0303 Japan

Web site: <http://www.yoshimura-jp.com> E-Mail: yj-world@yoshimura-jp.com