

SUZUKI GSX-R1000/R L7-M0 EEC Slip-On R-11Sq R

Be sure to read the instruction carefully before starting the work. It is necessary to follow the contents to install Yoshimura product.



- CAUTION** Before beginning installation, let motorcycle cool down.
- CAUTION** Be sure not to damage each part during installation.
- CAUTION** Torque specification must be followed. If neglected, it may cause bolt and nut to fall off and damage to Yoshimura product and motorcycle.
- CAUTION** Metal Magic sleeve is coated with heat-resistant paint. Handle with care not to be hit or scratched by surroundings as the coating may come off. When cleaning silencer, use soft cloth with dish soap but do not use metal polish or chemical cleaner.

1. Product Information :

Description	SUZUKI GSX-R1000/R L7-M0 EEC Slip-On R-11Sq R		Cyclone Type	S50AS1QC4
Part Number	Metal Magic Sleeve (SM)	: 1F0-50A-L12G0	Main Material	Stainless steel
	Satin Finish Sleeve (SSF)	: 1F0-50A-L13G0	Weight [STD : 3.8kg]	(SSF) & (SM) : 3.4kg
Homologation / Approved No.	EURO4 / e1 00055G			

2. Applicable Model :

Model	SUZUKI GSX-R1000/R L7-L8/L9-M0
-------	--------------------------------

3. Contents:

No.	Descriptions	Part No.	Q'ty	No.	Descriptions	Part No.	Q'ty
1	Tailpipe	1F5-50A-L100	1	5	Button Bolt M6x20	803-206-4020	2
2	Silencer Assy Metal Magic Sleeve	1F6-50A-L12G0	1	6	Washer M6x13	812-206-1310	2
	Silencer Assy Satin Finish Sleeve	1F6-50A-L13G0		7	Flange Nut M6	823-006-1000	2
3	Silencer Bracket	161-50A-0260	1	8	Exhaust Spring	118-001-0000	1
4	Washer M8x26	812-108-2600	1	9	Clamp Band	162-02215559	1

Parts Diagram

No. 9 is required to use only for the L9 and later models.

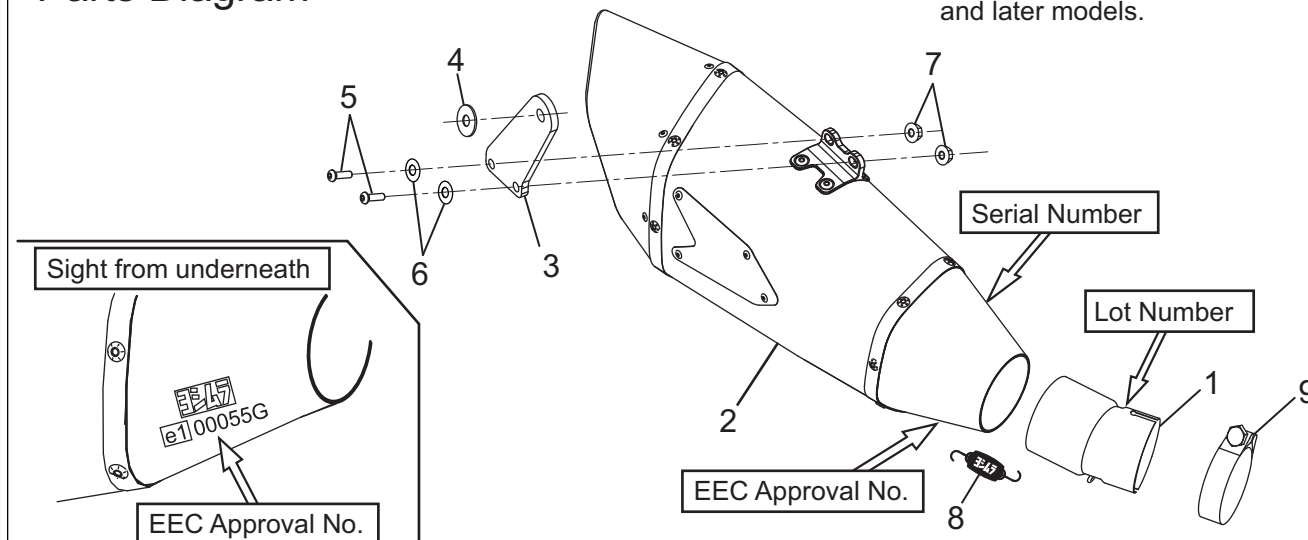

4. Optional Part :

Description	Part No.
Silencer Bracket Set	194-50A-0020
Carbon Heat Guard Set	194-50A-0030
Optional Exhaust Pipe for R-11Sq R	194-50A-0040

CAUTION

In combination with the EEC Slip-on R-11Sq R and Optional Exhaust Pipe, the silencer EEC Approval is invalid.

5. Installation steps:

CAUTION During the work, be careful not to damage each parts.

- 1) Check that all the component parts are in hand.
- 2) According to SUZUKI service manual, remove stock silencer assembly from vehicle (See Fig. 1).

CAUTION When removing stock silencer assembly, be careful not to damage swing arm and other components.



Fig. 1

- 3) Remove stock clamp band from stock silencer assembly if the vehicle is either 2017 or 2018 year model (See Fig. 2).

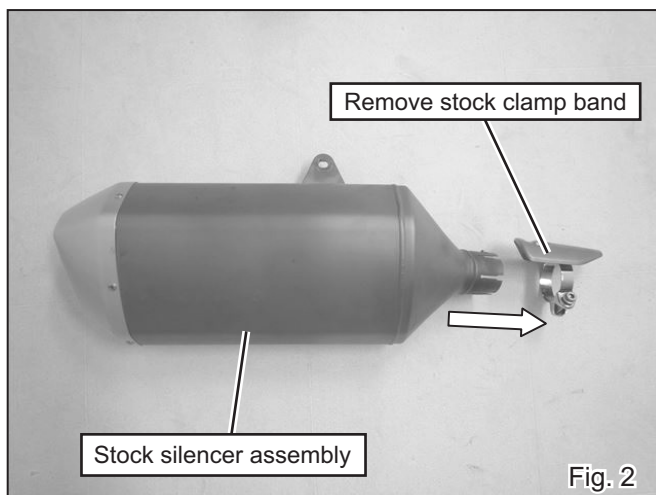

Fig. 2

- 4) Install SUZUKI genuine gasket into Tailpipe and attach either Clamp Band (2019 and later models) or stock clamp band (2017 and 2018 models) (See Fig. 3).

CAUTION Use SUZUKI genuine new gasket.

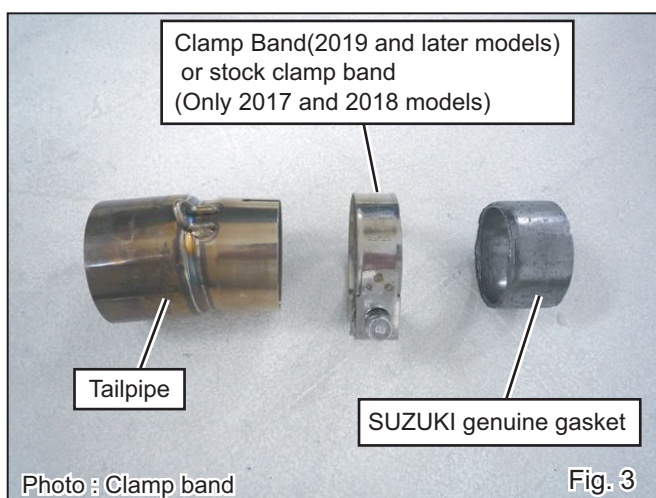

Fig. 3

- 5) Attach Silencer Bracket on to Silencer Assy with 2 of each Button Bolt M6x20, Washer M6x13 and Flange Nut M6 (See Fig. 4 & 5). Tighten the bolts by hand only at this stage.

- 6) Install Silencer Assy to Tailpipe and fix them with Exhaust Spring (See Fig 4 & 5).

CAUTION Make sure that exhaust spring is hooked to spring installation tool firmly. If neglected, it may cause injury.

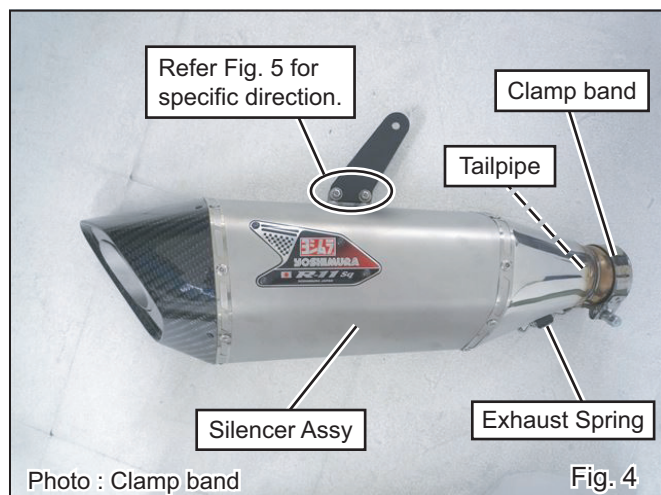

Fig. 4

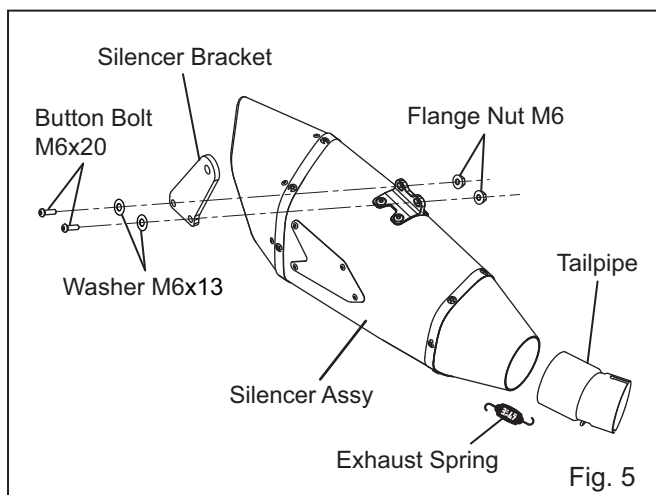

Fig. 5

- 7) Install Silencer Assy and Tailpipe (assembled at step. 6) to stock tailpipe. Then adjust the position of Silencer Bracket to stock silencer bracket, and tighten clamp band by hand (See Fig. 6).

- 8) Mount Silencer Assy to stock silencer bracket with stock bolt, washer, nut and Washer M8x26 (See Fig. 6 & 7). Tighten the bolt by hand only at this stage.

- 9) Check that there are proper clearances between Yoshimura slip-on and other components. Then, tighten and torque clamp band, Button Bolt M6x20 and stock bolt on Silencer Bracket in order (See Fig. 8 & 9).

Tightening Torque

Clamp Band	: 15Nm
Button Bolt M6x20	: 10Nm
Stock bolt on silencer bracket	: 23Nm

CAUTION Torque specification must be followed.

- 10) It is recommended that whole Yoshimura slip-on to be wiped down with dish soap to remove oil and fingerprints. This will prevent tarnishing of finish after the slip-on is heated up.

CAUTION When cleaning silencer, use soft cloth with dish soap. Do not use metal polish or parts cleaner. If neglect, the paint of Emblem and Metal Magic finish may come off.

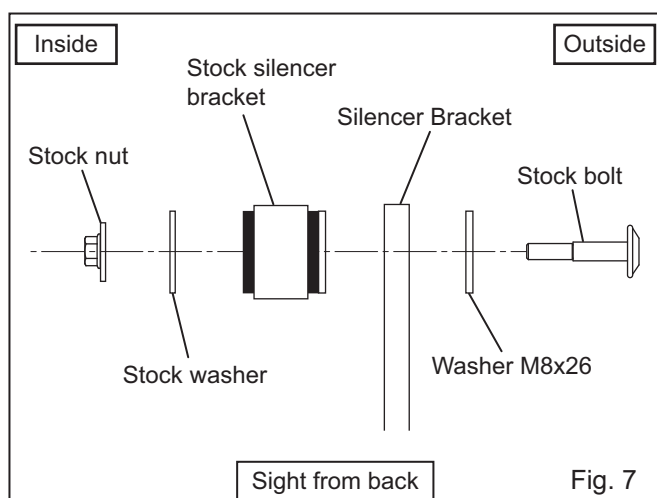
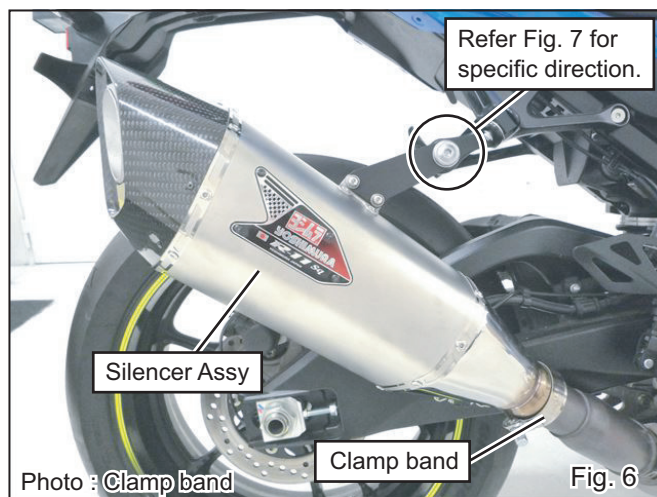

- 11) Warm-up engine, and inspect the exhaust leakage. Tighten all bolts and nuts further after engine is cooled down.
- 12) If "after fire" sounds severely, seal the gaps between Tailpipe and Silencer Assy with silicone gasket etc. Sealing gaps further after engine is cooled down.

After Installation L9 model with Carbon Heat Guard Set



! CAUTION

This exhaust is produced for street use only. In case that it is used on race circuit or tested on chassis dynamometer, any damage or carbon discoloration is not included in warranty.

! CAUTION

Yoshimura Japan recommends to replace silencer inner wool every 5,000km (3,000miles) in order to get Yoshimura exhaust performances fully.

However, inner wool possibly worn out faster under certain circumstances even if less mileage.

Climate conditions and riding styles are factors which directly result in inner wool worn out. Keeping high engine revolution also causes further wool consumption.

Using Yoshimura exhaust with deteriorated inner wool causes lower performance and may damage the silencer and vehicle.

For further information about inner wool replacement, please contact local Yoshimura distributors.

REFERENCE

Yoshimura Japan recommends to replace silencer inner wool when 50g of silencer weight is reduced.

- CAUTIONS AFTER INSTALLATION -

- ⦿ Check each bolt sometimes to see that there is no failure condition such as poor tightening.
- ⦿ Quality control is implemented on all products. If, however, any defect or failure is found, please notify Yoshimura Japan through the selling dealer. Necessary technical service or replacing of the product will be made.
- ⦿ Due to improvement, the specifications and price of the product are subject to change without notice.
- ⦿ For any information regarding this product, please address inquiries to Yoshimura Japan Co., Ltd.

Yoshimura Japan Co., Ltd.

6748 Nakatsu, Aikawa, Aiko, Kanagawa 243-0303 Japan

Web site: <http://www.yoshimura-jp.com> E-Mail: yj-world@yoshimura-jp.com