

## SUZUKI SV650/X STREET SPORTS TYPE-E SLIP-ON R-77J CARBON END

Product information



Be sure to read the instruction carefully before starting the work. It is necessary to follow the contents to install Yoshimura slip-on.

**CAUTION** Before beginning installation, let motorcycle cool down.

**CAUTION** Be sure not to damage each part during installation.

**CAUTION** Torque specification must be followed. If neglected, it may cause bolt and nut to fall off and damage to Yoshimura product and motorcycle.

**CAUTION** Metal Magic sleeve is coated with heat-resistant paint. Handle with care not to be hit or scratched by surroundings as the coating may come off. When cleaning silencer, use soft cloth with dish soap but do not use metal polish or chemical cleaner.

### 1. Product Information :

| Description | SUZUKI SV650 Street Sports Type-E Slip-on R-77J Carbon End |                      |                      |
|-------------|--|----------------------|----------------------|
| Part Number | Metal Magic Sleeve (SMC) : 170-169-5W21                    | Cyclone Type         | S169S77C1            |
|             | Satin Finish Sleeve (SSFC) : 170-169-5W31                  | Main Material        | Stainless steel      |
|             | Stainless Sleeve (SSC) : 170-169-5W51                      | Weight [STD : 2.8kg] | SMC/SSFC/SSC : 3.2kg |

### 2. Applicable Model :

|       |                       |
|-------|-----------------------|
| Model | SUZUKI SV650 / SV650X |
|-------|-----------------------|

### 3. Contents :

| No. | Descriptions          | Part No.     | Q'ty | No. | Descriptions         | Part No.     | Q'ty |
|-----|-----------------------|--------------|------|-----|----------------------|--------------|------|
| 1   | Silencer Assy, (SMC)  | 1F6-169-5W21 | 1    | 3   | Silencer Band        | 162-CAX-1321 | 1    |
|     | Silencer Assy, (SSFC) | 1F6-169-5W31 |      | 4   | Silencer Band Rubber | 896-016-0835 | 1    |
|     | Silencer Assy, (SSC)  | 1F6-169-5W51 |      | 5   | Exhaust Spring       | 118-001-0000 | 2    |
| 2   | Tailpipe              | 115-169-5V00 | 1    |     |                      |              |      |

### Parts Diagram

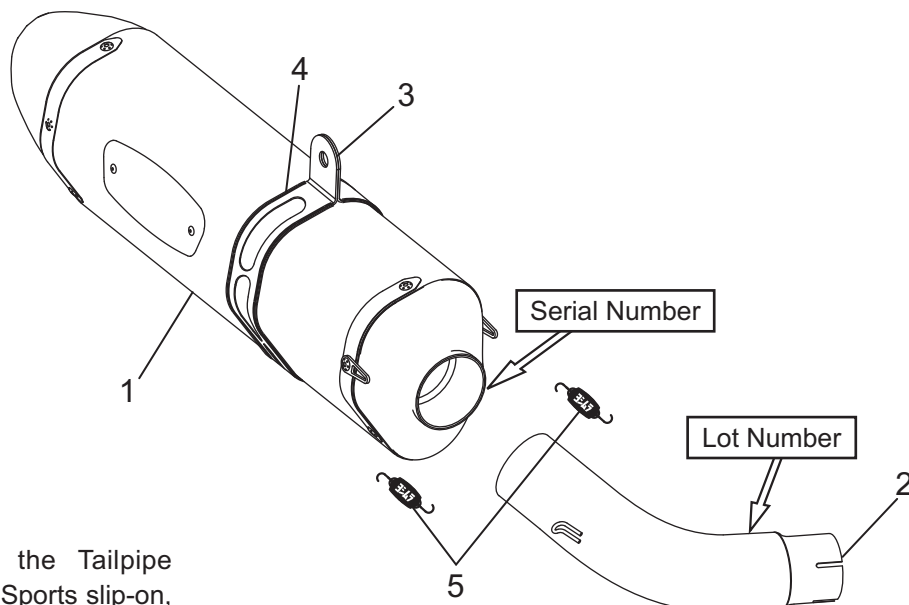

**CAUTION**  
In combination with the Tailpipe attached to this Street Sports slip-on, the EEC Approval is not valid.

## 4. Installation Procedures:

- 1) Check that all components are in hand.
- 2) According to Suzuki Service Manual, remove stock silencer assembly.

**CAUTION** When removing stock silencer assembly, be careful not to damage swing arm or other components.

**REFERENCE** Stock bolt, washer and nut removed at this stage are reused when mounting Yoshimura slip-on.

- 3) Remove stock clamp band from stock silencer assembly removed at step 2. (See Fig. 1)

**REFERENCE** Stock clamp band removed at this stage is reused when mounting Yoshimura slip-on.

- 4) Insert Suzuki genuine gasket into front of Tailpipe and install stock clamp band removed at step 3. (See Fig. 2)

**CAUTION** Use SUZUKI genuine new gasket.

- 5) Mount Tailpipe on stock exhaust pipe. (See Fig. 3) Tighten clamp band by hand only at this stage.

- 6) Mount Silencer Assy on Tailpipe. (See Fig. 4)

- 7) Place Silencer Band Rubber inside Silencer Band, and put the Silencer Band on Silencer Assy. Then, fix the Silencer Band on stock silencer bracket with stock bolt, washer and nut removed at step 2. (See Fig. 4 & 5 on next page) Tighten bolt by hand only at this stage.

**REFERENCE** Cut excess of Silencer Band Rubber with scissors etc. when placing it inside Silencer Band.

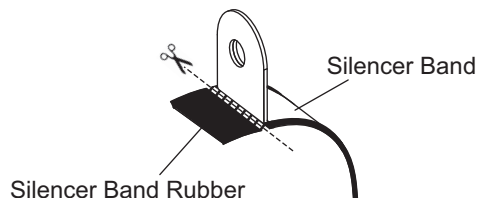

**CAUTION** Be sure to place Silencer Band at right angles to Silencer Assy. If neglected, it may cause breakage to Silencer Band.

**CAUTION** Before hand-tighten Silencer Band, make sure silencer sleeve and Silencer Band fit evenly and there is no opening between them. If neglected, it may cause deformation of silencer sleeve.

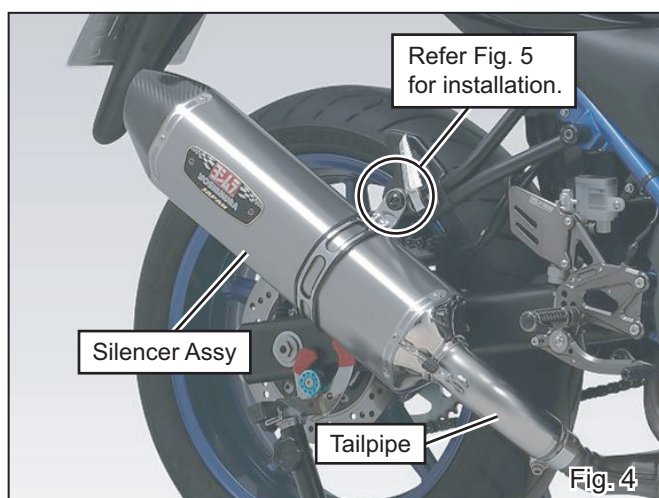
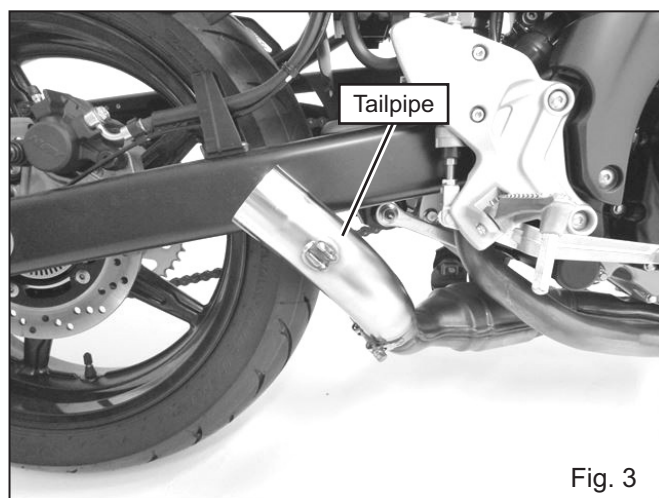
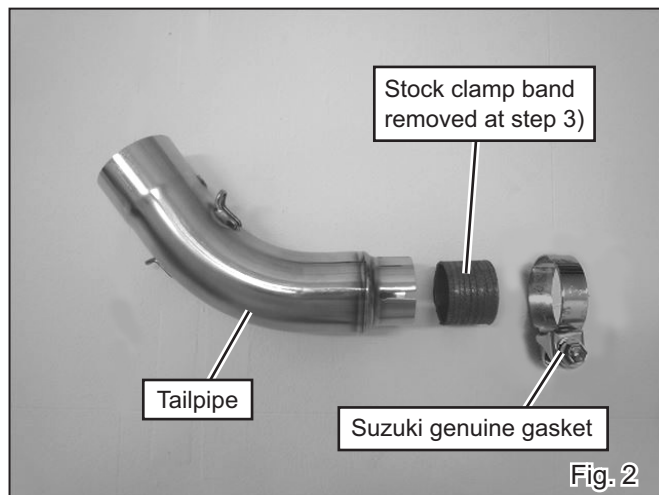
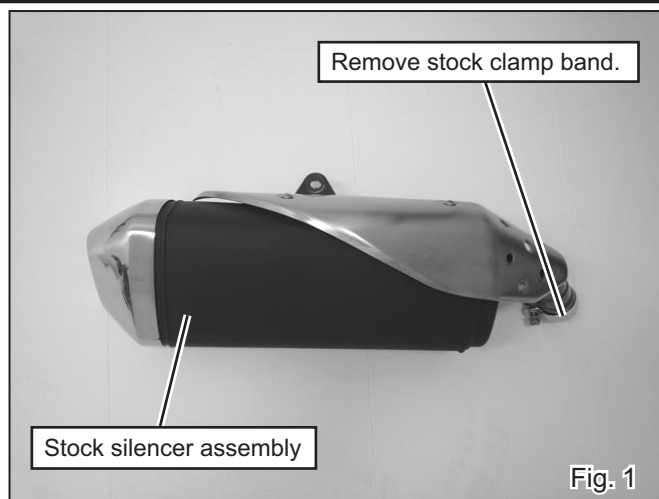

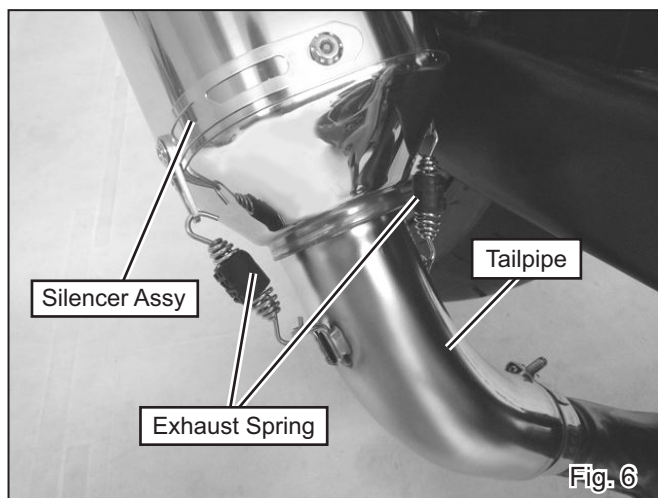
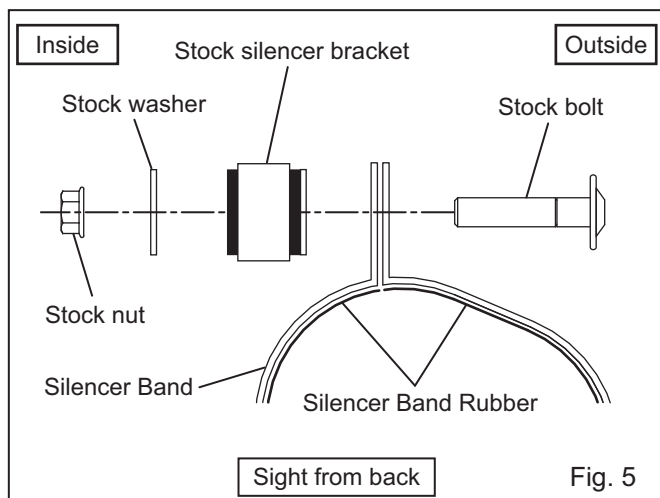

- 8) Install 2 of Exhaust Springs on each spring hook. (See Fig. 6 )

**CAUTION** Make sure that exhaust spring is hooked to installing tool firmly. If neglected, it may cause injury.

- 9) Check from back and adjust angle of Silencer Assy and keep proper clearance between Yoshimura slip-on and other components such as swing arm. Tighten and torque stock clamp band and stock bolt in the order. (See Fig. 7)

|                          |            |        |
|--------------------------|------------|--------|
| <b>Tightening Torque</b> | Clamp Band | : 18Nm |
|                          | Stock bolt | : 23Nm |

**CAUTION** Torque specification must be followed.

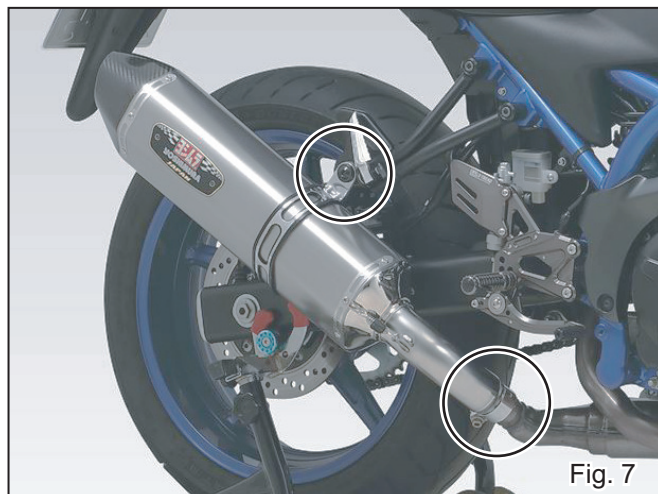

- 10) Make sure to keep enough clearance between Yoshimura slip-on and swing arm or other components. In case there is no clearance, loosen bolts on clamp band and Silencer Band, and readjust the position.

- 11) It is recommended that whole slip-on to be wiped down with dish soap to remove oil and fingerprints. This will prevent from tarnishing of finish after slip-on heats up.

**CAUTION** When cleaning silencer, use soft cloth with dish soap. Do not use metal polish or parts cleaner. If neglected, the paint of Emblem and Metal Magic finish may come off.

- 12) Warm-up engine, and inspect exhaust leaking. If "after fire" sounds severely, seal gaps of joints between pipes with heat resistant silicone gasket etc.

**CAUTION** Before beginning the work, let motorcycle cool down.

**REFERENCE** It is normal for new silencer to smoke until inside oil residue burns off.

- 13) Tighten all bolts further after engine cools down. If any problem is found, please follow through instruction steps again carefully.

## ***After Installation***



### **! CAUTION**

This exhaust is produced for street use only. In case that it is used on race circuit or tested on chassis dynamometer, any damage or carbon discoloration is not included in warranty.

### **REFERENCE**

Yoshimura Japan recommends silencer inner wool replacement every 5,000km (3,000miles) in order to get Yoshimura exhaust performance fully. Climate, riding condition, and frequency of ride are direct contributing factors for inner wool worn out. Keeping high engine revolution also promote further wool consumption. For silencer repairing, please contact local Yoshimura distributor for further information.

#### **- CAUTIONS AFTER INSTALLATION -**

- ◎ Check each bolt sometimes to see that there is no failure condition such as poor tightening.
- ◎ Quality control is implemented on all products. If, however, any defect or failure is found, please notify Yoshimura Japan through the selling dealer. Necessary technical service or replacing of the product will be made.
- ◎ Due to improvement, the specifications and price of the product are subject to change without notice.
- ◎ For any information regarding this product, please address inquiries to Yoshimura Japan Co., Ltd.

Yoshimura Japan Co., Ltd.

6748 Nakatsu, Aikawa, Aiko, Kanagawa 243-0303 Japan

Web site: <http://www.yoshimura-jp.com> E-Mail: [yj-world@yoshimura-jp.com](mailto:yj-world@yoshimura-jp.com)