

## KTM 1290 SUPER DUKE R EEC SLIP-ON R-11 SINGLE EXIT

Be sure to read the instruction carefully before starting the work. It is necessary to follow the contents to install Yoshimura product.

Product information



- CAUTION** Before beginning installation, let motorcycle cool down.
- CAUTION** Be sure not to damage each part during installation.
- CAUTION** Torque specification must be followed. If neglected, it may cause bolt and nut to fall off and damage to Yoshimura product and motorcycle.
- CAUTION** Metal Magic sleeve is coated with heat-resistant paint. Handle with care not to be hit or scratched by surroundings as the coating may come off. When cleaning silencer, use soft cloth with dish soap but do not use metal polish or chemical cleaner.
- CAUTION** Titanium Blue sleeve is colored by anodizing. Handle with care as the color may change. When cleaning silencer, use soft cloth with dish soap but do not use metal polish or chemical cleaner.

### 1. Product Information :

Description	KTM 1290 SUPER DUKE R EEC Slip-On R-11 Single Exit	Main Material	Stainless steel
Part Number	Satin Finish Sleeve (SSF) : 1A0-668-5E30	Homologation / Approved No.	EURO3 / e3 1172⑨
	Metal Magic Sleeve (SM) : 1A0-668-5E20		
	Titanium Blue Sleeve (STB) : 1A0-668-5E80B	Weight	(SSF) & (SM) : 2.0kg
Cyclone Type	G668S11C1	[STD : 2.8kg]	(STB) : 1.8kg

### 2. Applicable Model :

Model	KTM 1290 SUPER DUKE R(14-15)
Engine Type	613

### 3. Contents:

No.	Descriptions	Part No.	Q'ty	No.	Descriptions	Part No.	Q'ty
1	Tailpipe	1A5-668-5E00	1	6	Washer M8x20	812-108-2000	2
2	Silencer Assy Satin Finish Sleeve	1A6-668-5E30	1	7	Washer M6x13	812-206-1310	2
	Silencer Assy Metal Magic Sleeve	1A6-668-5E20		8	Flange Nut M6	823-006-1000	2
	Silencer Assy Titanium Blue Sleeve	1A6-668-5E80B		9	Spacer 6-10-15	860-006-1015	2
3	Silencer Bracket	161-668-0200	1	10	Grommet Rubber	875-511-1006	1
4	Button Bolt M6x35	803-206-4035	2	11	Grommet Spacer	850-108-1010	1
5	Cap Bolt M8x25	800-208-5025	1	12	Exhaust Spring	118-001-0000	2

### Parts Diagram

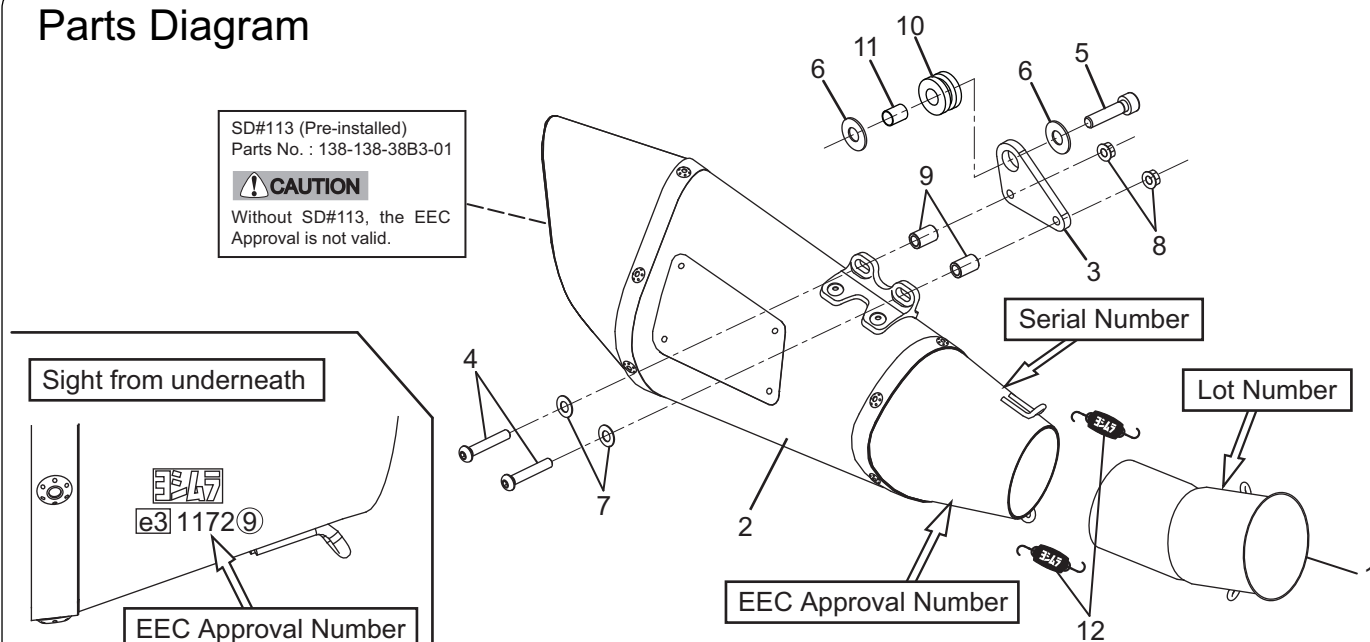

## 4. Installation steps:

- 1) Check that all the component parts are in hand.
- 2) According to KTM service manual, remove stock silencer assembly from vehicle. Stock gasket and clamp band are reused when installing Yoshimura slip-on (See Fig. 1).

**CAUTION** When removing stock silencer assembly, be careful not to damage rear wheel and other components.



Fig. 1

- 3) Attach Grommet Rubber and Grommet Spacer to Silencer Bracket (See Fig. 2).

- 4) Install Tailpipe to Silencer Assy and fix them with 2 of Exhaust Spring (See Fig. 3 & 4).

**CAUTION** Make sure that exhaust spring is hooked to spring installation tool firmly. If neglected, it may cause injury.

**REFERENCE** When installing Tailpipe to Silencer Assy, engraved mark on Tailpipe must point toward to the vehicle.

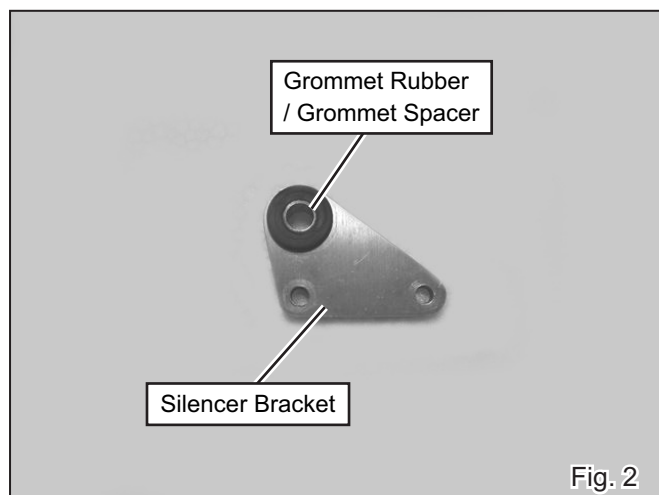

Fig. 2

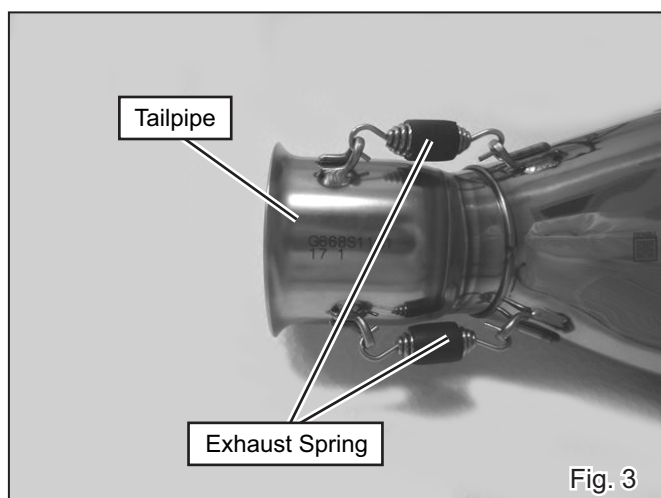

Fig. 3

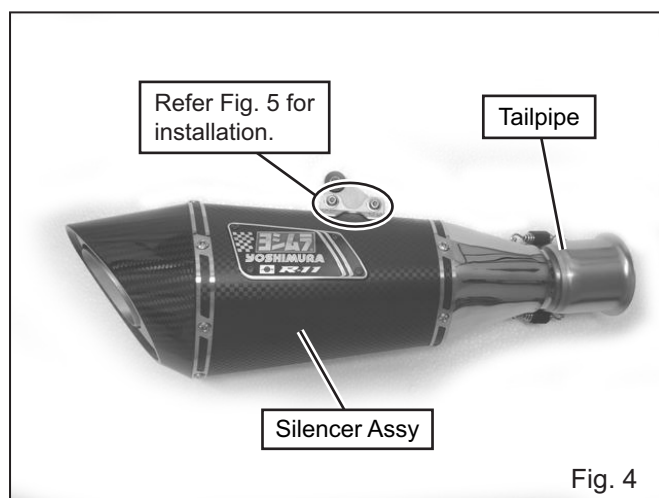

Fig. 4

- 5) Attach Silencer Bracket on to Silencer Assy with 2 of each Button Bolt M6x35, Washer M6x13, Spacer 6-10-15 and Flange Nut M6 (See Fig. 4 & 5). Tighten bolts by hand only at this stage.

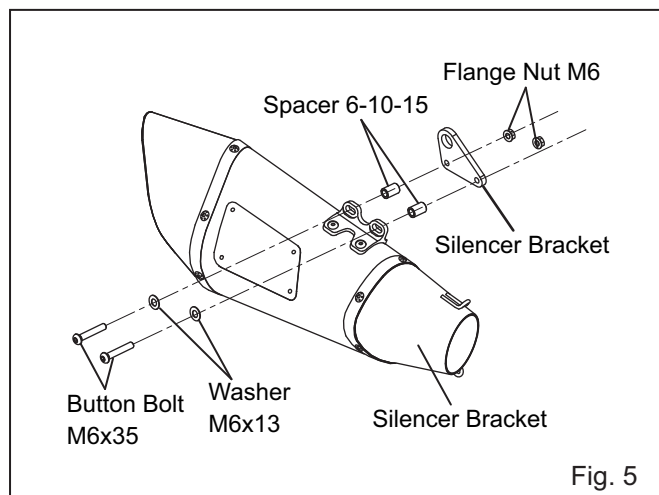

Fig. 5

6) Install stock gasket and clamp band which removed at Step. 2. on to Tailpipe. Then, install the assembled silencer to stock tailpie (See Fig 6). Tighten the clamp band by hand only at this stage.

7) Mount Silencer Assy to stock silencer bracket with Cap Bolt M8x25 and 2 of Washer M8x20 (See Fig 7 & 8). Tighten the bolt by hand only at this stage.

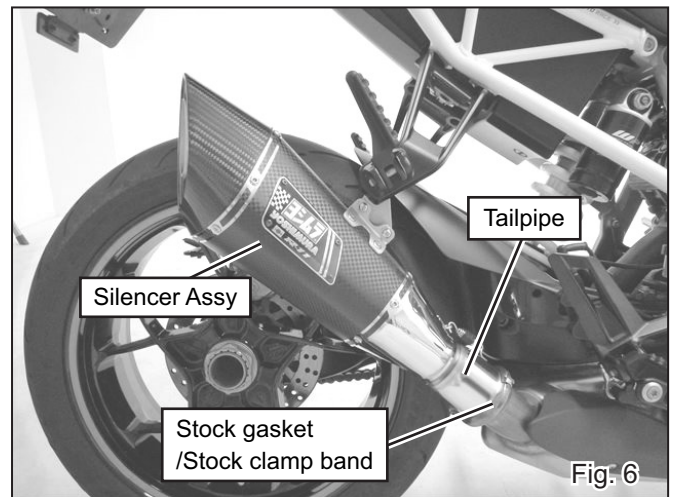

Fig. 6

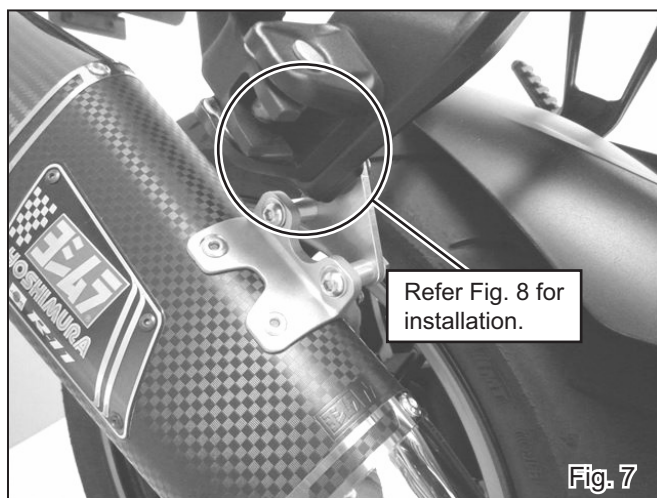

Fig. 7

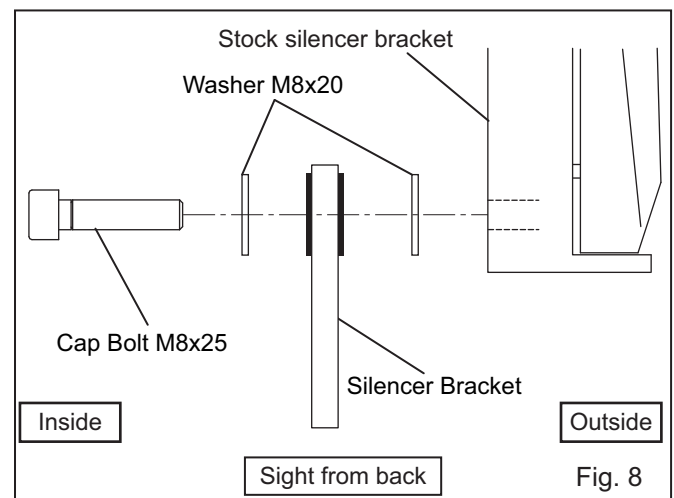

Fig. 8

8) Check that there are proper clearances between Yoshimura slip-on and other components. Then, tighten and torque stock clamp band, Button Bolt M6x35 and Cap Bolt M8x25 in order (See Fig. 9).

<b>Tightening Torque</b>	Stock clamp band	: 10 Nm
	Button Bolt M6x35	: 10 Nm
	Cap Bolt M8x25	: 23 Nm

**CAUTION** Torque specification must be followed.

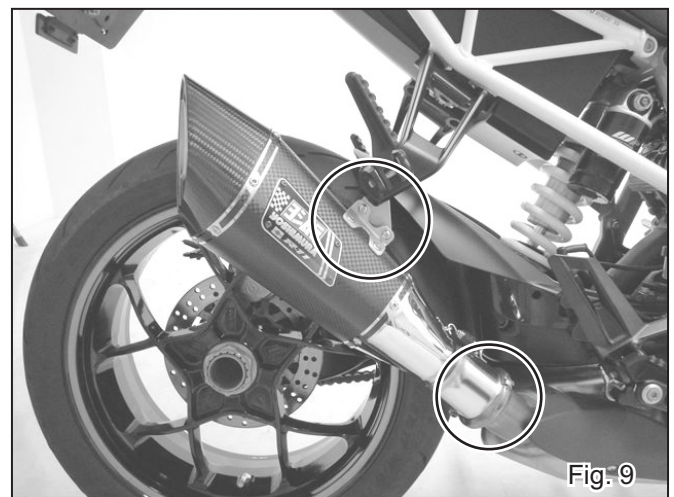

Fig. 9

9) Check that there are proper clearance between Yoshimura slip-on and other components. In case there is not enough clearance, loosen bolts and readjust the position of Yoshomura slip-on.

10) It is recommended that whole Yoshimura slip-on to be wiped down with dish soap to remove oil and fingerprints. This will prevent tarnishing of finish after the slip-on is heated up.

**CAUTION** When cleaning silencer, use soft cloth with dish soap. Do not use metal polish or parts cleaner. If neglect, the paint of Emblem and Metal Magic finish may come off or Titanium Blue color may tarnish.

- 11) Warm-up engine, and inspect the exhaust leakage. Tighten all bolts and nuts further after engine is cooled down.
- 12) If "after fire" sounds severely, seal the gaps between Tailpipe and Silencer Assy with silicone gasket etc. Sealing gaps further after engine is cooled down.



**! CAUTION**

Titanium Blue sleeve is colored by anodizing. Handle with care as the color may change. When cleaning silencer, use soft cloth with dish soap but do not use metal polish or chemical cleaner.

**! CAUTION**

This exhaust is produced for street use only. In case that it is used on race circuit or tested on chassis dynamometer, any damage or carbon discoloration is not included in warranty.

**REFERENCE**

Yoshimura Japan recommends silencer inner wool replacement every 5,000km (3,000miles) in order to get Yoshimura exhaust performance fully. Climate, riding condition, and frequency of ride are direct contributing factors for inner wool worn out. Keeping high engine revolution also promotes further wool consumption. For silencer repairing, please contact local Yoshimura distributor for further information.

**- CAUTIONS AFTER INSTALLATION -**

- ⦿ Check each bolt sometimes to see that there is no failure condition such as poor tightening.
- ⦿ Quality control is implemented on all products. If, however, any defect or failure is found, please notify Yoshimura Japan through the selling dealer. Necessary technical service or replacing of the product will be made.
- ⦿ Due to improvement, the specifications and price of the product are subject to change without notice.
- ⦿ For any information regarding this product, please address inquiries to Yoshimura Japan Co., Ltd.

Yoshimura Japan Co., Ltd.

6748 Nakatsu, Aikawa, Aiko, Kanagawa 243-0303 Japan

Web site: <http://www.yoshimura-jp.com> E-Mail: [yj-world@yoshimura-jp.com](mailto:yj-world@yoshimura-jp.com)