

SUZUKI GSX-R1000/R STREET SPORTS SLIP-ON R-11Sq

Be sure to read the instruction carefully before starting the work. It is necessary to follow the contents to install Yoshimura product.

Product information



- CAUTION** Before beginning installation, let motorcycle cool down.
- CAUTION** Be sure not to damage each part during installation.
- CAUTION** Torque specification must be followed. If neglected, it may cause bolt and nut to fall off and damage to Yoshimura product and motorcycle.
- CAUTION** Metal Magic sleeve is coated with heat-resistant paint. Handle with care not to be hit or scratched by surroundings as the coating may come off. When cleaning silencer, use soft cloth with dish soap but do not use metal polish or chemical cleaner.
- CAUTION** Titanium Blue sleeve is colored by anodizing. Handle with care as the color may change. When cleaning silencer, use soft cloth with dish soap but do not use metal polish or chemical cleaner.

1. Product Information :

Description	SUZUKI GSX-R1000/R Street Sports Slip-On R-11Sq	Cyclone Type	S50AS1QC2
Part Number	Stainless Sleeve (SS) : 180-50A-L15G2	Main Material	Stainless steel
	Metal Magic Sleeve (SM) : 180-50A-L12G2	Weight [STD : 3.8kg]	(SS) & (SM) : 2.7kg
	Titanium Sleeve (ST) : 180-50A-L18G2		(ST) & (STB) : 2.5kg
	Titanium Blue Sleeve (STB) : 180-50A-L16G2		

2. Applicable Model :

Model	SUZUKI GSX-R1000/R ('17-'22)
-------	------------------------------

3. Contents:

No.	Descriptions	Part No.	Q'ty	No.	Descriptions	Part No.	Q'ty
1	Tailpipe	185-50A-L100	1	4	Washer M8x26	812-108-2600	1
2	Silencer Assy Stainless Sleeve	186-50A-L15G0	1	5	Button Bolt M6x20	803-206-4020	2
	Silencer Assy Metal Magic Sleeve	186-50A-L12G0		6	Washer M6x13	812-206-1310	2
	Silencer Assy Titanium Sleeve	186-50A-L18G0		7	Flange Nut M6	823-006-1000	2
	Silencer Assy Titanium Blue Sleeve	186-50A-L16G0		8	Exhaust Spring	118-001-0000	1
3	Silencer Bracket	161-50A-0230	1	9	Clamp Band	162-02215559	1

4. Optional Part :

Description	Part No.
Optional Exhaust Pipe	194-50A-0010
Silencer Bracket Set	194-50A-0020
Carbon Heat Guard Set	194-50A-0030

Parts Diagram

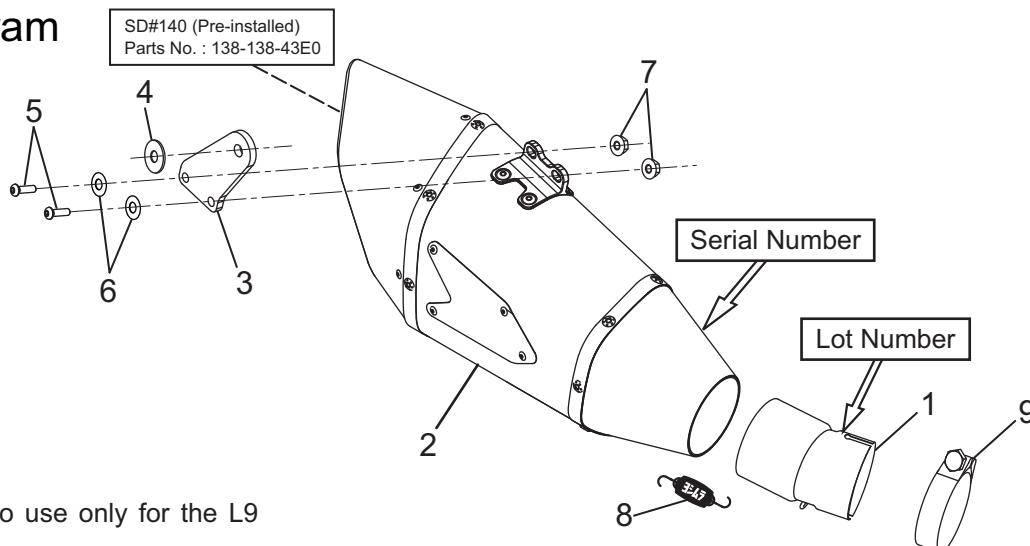

No. 9 is required to use only for the L9 and later models.

5. Installation steps:

! CAUTION * During the work, be careful not to damage each parts.

- 1) Check that all the component parts are in hand.
- 2) According to SUZUKI service manual, remove stock silencer assembly from vehicle (See Fig. 1).

! CAUTION When removing stock silencer assembly, be careful not to damage swing arm and other components.

- 3) Remove stock clamp band from stock silencer assembly if the vehicle is either 2017 or 2018 year model (See Fig. 2).

- 4) Install SUZUKI genuine gasket into Tailpipe and attach either Clamp Band (2019 and later models) or stock clamp band (2017 and 2018 models) (See Fig. 3).

! CAUTION Use SUZUKI genuine new gasket.

- 5) Attach Silencer Bracket on to Silencer Assy with 2 of each Button Bolt M6x20, Washer M6x13 and Flange Nut M6 (See Fig. 4 & 5). Tighten the bolts by hand only at this stage.

- 6) Install Silencer Assy to Tailpipe and fix them with Exhaust Spring (See Fig 4 & 5).

! CAUTION Make sure that exhaust spring is hooked to spring installation tool firmly. If neglected, it may cause injury.



Fig. 1

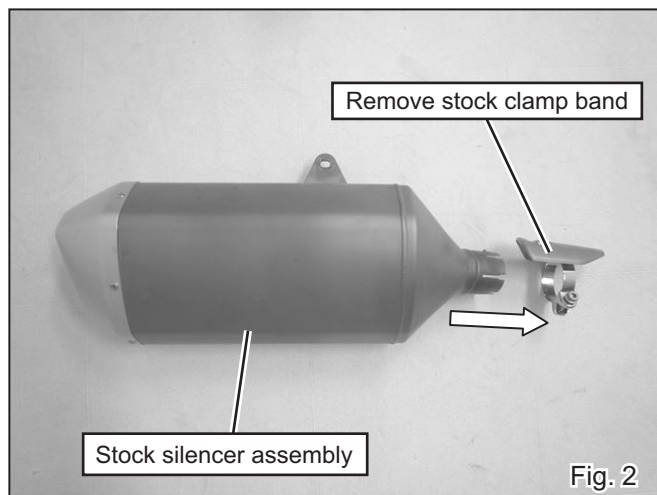

Fig. 2

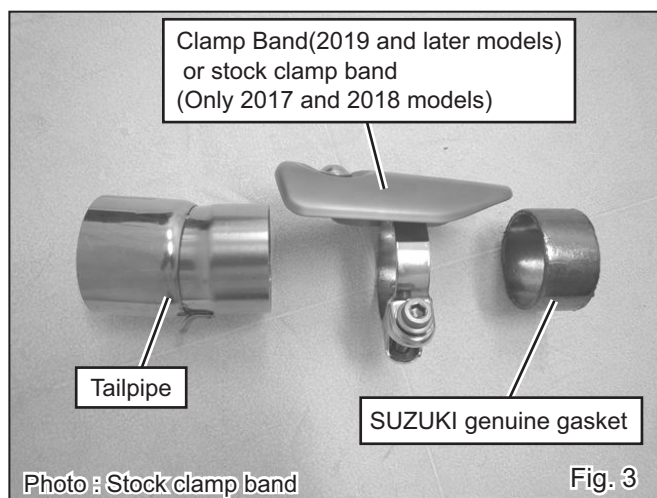

Fig. 3

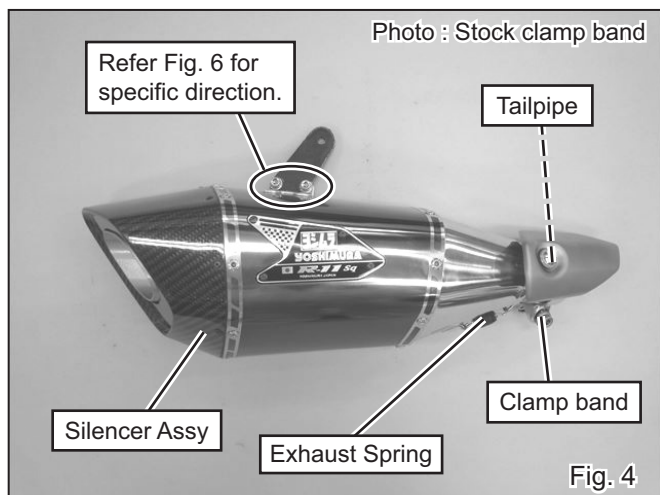

Fig. 4

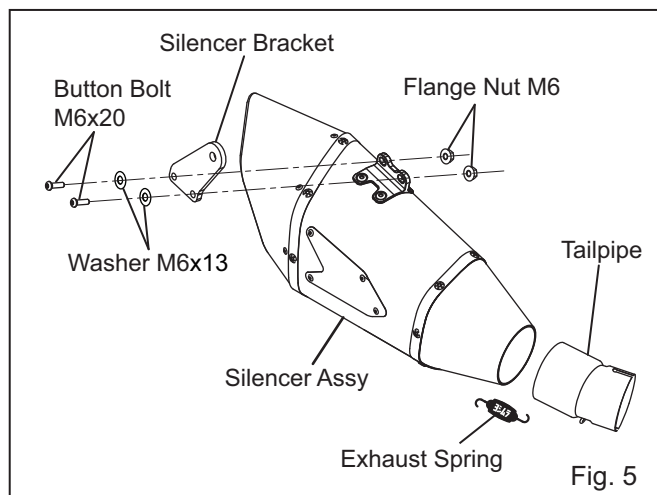

Fig. 5

- 7) Install Silencer Assy and Tailpipe (assembled at step. 6) to stock tailpipe. Then adjust the position of Silencer Bracket to stock silencer bracket, and tighten clamp band by hand (See Fig. 6 & 7).

- 8) Mount Silencer Assy to stock silencer bracket with stock bolt, washer, nut and Washer M8x26 (See Fig. 6 & 7). Tighten the bolt by hand only at this stage.

- 9) Check that there are proper clearances between Yoshimura slip-on and other components. Then, tighten and torque clamp band, Button Bolt M6x20 and stock bolt on Silencer Bracket in order (See Fig. 8).

Tightening Torque

Clamp Band	: 15Nm
Button Bolt M6x20	: 10Nm
Stock bolt on silencer bracket	: 23Nm

CAUTION Torque specification must be followed.

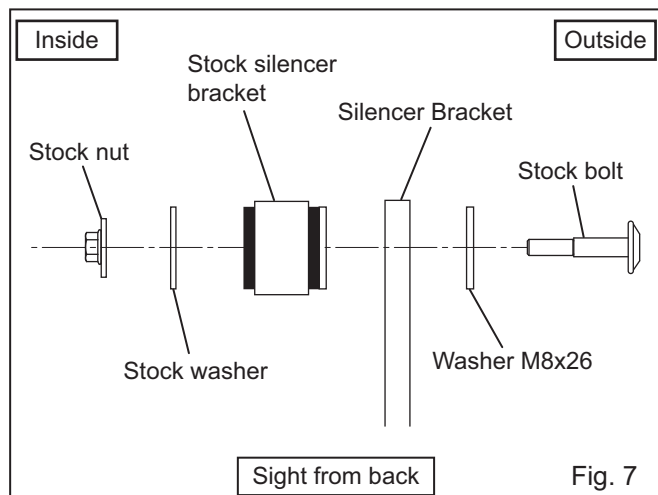
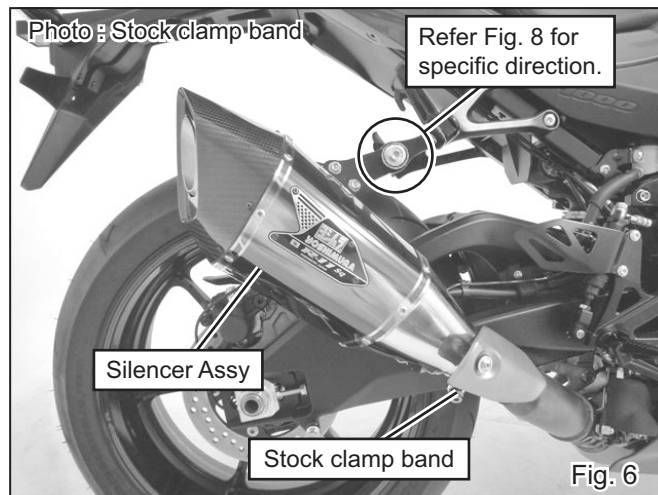

- 10) It is recommended that whole Yoshimura slip-on to be wiped down with dish soap to remove oil and fingerprints. This will prevent tarnishing of finish after the slip-on is heated up.

CAUTION When cleaning silencer, use soft cloth with dish soap. Do not use metal polish or parts cleaner. If neglect, the paint of Emblem and Metal Magic finish may come off or Titanium Blue color may tarnish.

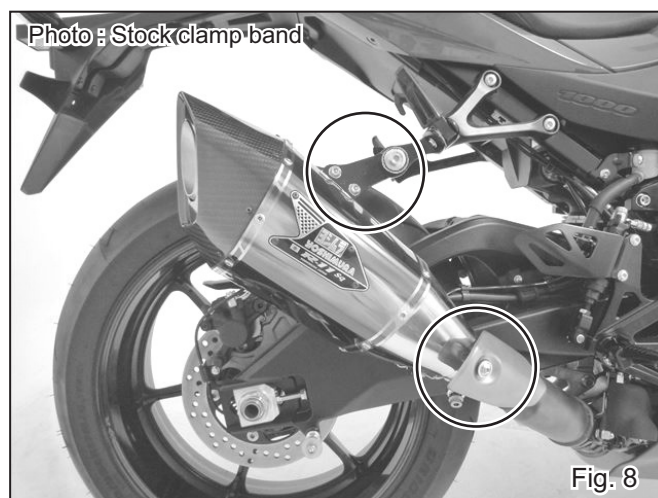

- 11) Warm-up engine, and inspect the exhaust leakage. Tighten all bolts and nuts further after engine is cooled down.
- 12) If "after fire" sounds severely, seal the gaps between Tailpipe and Silencer Assy with silicone gasket etc. Sealing gaps further after engine is cooled down.

After Installation (17-18)



After Installation (19-22)



! CAUTION

When using Street Sports Slip-on R-11Sq for GSX-R1000/R L7 (P/N. 180-50A-Lxxxx), it is highly recommended to NOT take out dB killer SD#140 from silencer assy.

If neglected, any trouble/damage is not included in warranty.

If the pre-installed SD#140 is removed, there is a possibility of heat damage to the RH rear turn signal. It is recommend to removal or relocation of the turn signal to avoid heat damage.

For track-day use we recommend SD#140 remains installed to observe track noise limits. If removing the SD#140, it is highly recommended to remove or relocate the RH rear turn signal to avoid heat damage.

! CAUTION

Titanium Blue sleeve is colored by anodizing. Handle with care as the color may change. When cleaning silencer, use soft cloth with dish soap but not use metal polish or chemical cleaner.

! CAUTION

This exhaust is produced for track-day use or for areas where it is not necessary to use a fully legal exhaust. If it is used for racing or on a chassis dynamometer, any damage or carbon discoloration is not included in warranty.

! CAUTION

Yoshimura Japan recommends to replace silencer inner wool every 5,000km (3,000miles) in order to get Yoshimura exhaust performances fully.

However, inner wool possibly worn out faster under certain circumstances even if less mileage.

Climate conditions and riding styles are factors which directly result in inner wool worn out. Keeping high engine revolution also causes further wool consumption.

Using Yoshimura exhaust with deteriorated inner wool causes lower performance and may damage the silencer and vehicle.

For further information about inner wool replacement, please contact local Yoshimura distributors.

REFERENCE

Yoshimura Japan recommends to replace silencer inner wool when 50g of silencer weight is reduced.

- CAUTIONS AFTER INSTALLATION -

- ⊙ Check each bolt sometimes to see that there is no failure condition such as poor tightening.
- ⊙ Quality control is implemented on all products. If, however, any defect or failure is found, please notify Yoshimura Japan through the selling dealer. Necessary technical service or replacing of the product will be made.
- ⊙ Due to improvement, the specifications and price of the product are subject to change without notice.
- ⊙ For any information regarding this product, please address inquiries to Yoshimura Japan Co., Ltd.

Yoshimura Japan Co., Ltd.

6748 Nakatsu, Aikawa, Aiko, Kanagawa 243-0303 Japan

Web site: <http://www.yoshimura-jp.com> E-Mail: yj-world@yoshimura-jp.com