



Z900RS/Z900RS CAFE STREET SPORTS / FULL SYSTEM BST-V

Be sure to read the instruction carefully before starting the work. It is necessary to follow the contents to install Yoshimura product.

Product information



- ! CAUTION** Before beginning installation, let motorcycle cool down.
- ! CAUTION** Be sure not to damage each part during installation.
- ! CAUTION** Torque specification must be followed. If neglected, it may cause bolt and nut to fall off and damage to Yoshimura product and motorcycle.
- ! CAUTION** This product is coated with heat-resistant paint. Handle with care not to be hit or scratched by surroundings as the coating may come off. Use soft cloth with dish soap but do not use high-pressure washer when cleaning the exhaust system. Do not use metal polish, parts cleaner or similar chemicals either, and be cautious that some detergent may damage the paint. Note that paint peeling problem is not under warranty.

1. Product Information :

| | | | |
|--------------|---|-----------------------|-----------------|
| Description | Kawasaki Z900RS / Z900RS CAFE STREET SPORTS / FULL SYSTEM BST-V | | |
| Cyclone Type | K269HFST11 | Main Material | Stainless steel |
| Part Number | 180-269-6660 | Weight [STD : 12.0kg] | 6.4kg |

2. Applicable Model :

| | |
|-------|---|
| Model | Kawasaki Z900RS(18-22/23)/Z900RS CAFE(18-22/23) |
|-------|---|

3. Contents:

| No. | Descriptions | Part No. | Q'ty | No. | Descriptions | Part No. | Q'ty |
|-----|------------------|--------------|------|-----|---------------|--------------|------|
| 1 | Muffler Assy | 187-269-6660 | 1 | 7 | Washer M6x13 | 812-206-1310 | 2 |
| 2 | Connector#139 | 136-269-2D90 | 8 | 8 | Flange Nut M6 | 823-006-1000 | 2 |
| 3 | Cast Flange | 117-045-0250 | 3 | 9 | Plug | 862-118-1500 | 1 |
| 4 | Cast Flange#3 | 117-045-3200 | 1 | 10 | Washer | 812-318-0000 | 1 |
| 5 | Silencer Blacekt | 161-269-0300 | 1 | * | Tie wrap L100 | 831-002-0100 | 1 |
| 6 | Cap Bolt M6x20 | 800-206-4020 | 2 | | | | |

Parts Diagram

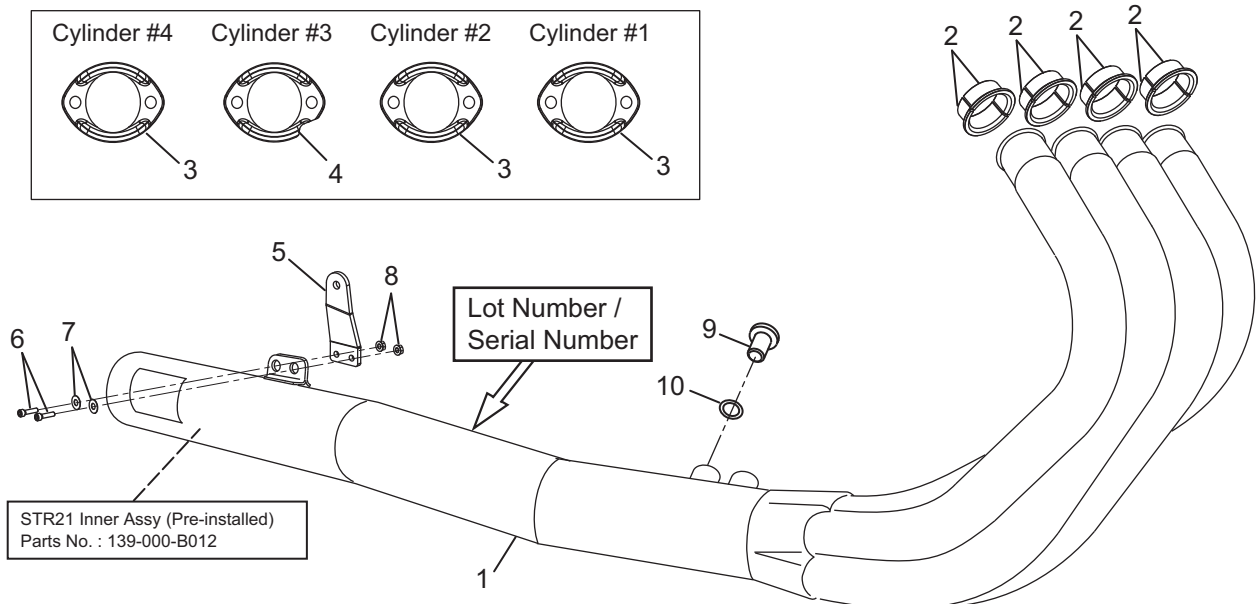

! Check exhaust gas and confirm Air by Fuel ratio is within safe area after mounting the full system. Adjust the FI mapping if it is necessary.
 This full system is possible to remove a baffle (STR21 Inner Assy). It is highly recommended to adjust FI mapping when running without STR21 Inner Assy.