

KAWASAKI ZX-6R (09-21) / ZX-6R 636 (13-22) STREET SPORTS SLIP-ON R-11 SINGLE EXIT

Product information



Be sure to read the instruction carefully before starting the work. It is necessary to follow the contents to install Yoshimura exhaust system.

1. Product Information :

Description	Kawasaki ZX-6R (09-21) / ZX-6R 636 (13-22) Street Sports Slip-on R-11 Single Exit		
Cyclone Type	KS264S11C1	Main Material	Stainless steel
Weight [STD 5.0kg]	Metal Magic Sleeve (SM) ; 2.0kg	Part Number	Metal Magic Sleeve (SM) ; 170-264-5E20
	Titanium Sleeve (ST) ; 1.8kg		Titanium Sleeve (ST) ; 170-264-5E80

2. Applicable Model :

Model	Kawasaki ZX-6R (09-21) / ZX-6R 636 (13-22)
Type of Engine	ZX600PE (09-21) / ZX636EE (13-22)

3. Optional Part :

Description	Part No.
CARBON HEAT GUARD SET TYPE-2	161-000-A620

4. Contents :

No.	Descriptions	Part No.	Q'ty	No.	Descriptions	Part No.	Q'ty
1	Tailpipe	115-264-5E00	1	4	Button Bolt M6x20	803-206-4020	2
2	Silencer Assy, (SM)	1A6-264-5E20	1	5	Washer M6	812-206-1310	2
	Silencer Assy, (ST)	1A6-264-5E80		6	Flange Nut M6	823-006-1000	2
3	Silencer Bracket	161-264-0200	1	7	Exhaust Spring	118-001-0000	2

Parts Diagram

SD#74 (Pre-installed)
Parts No. : 138-138-3274

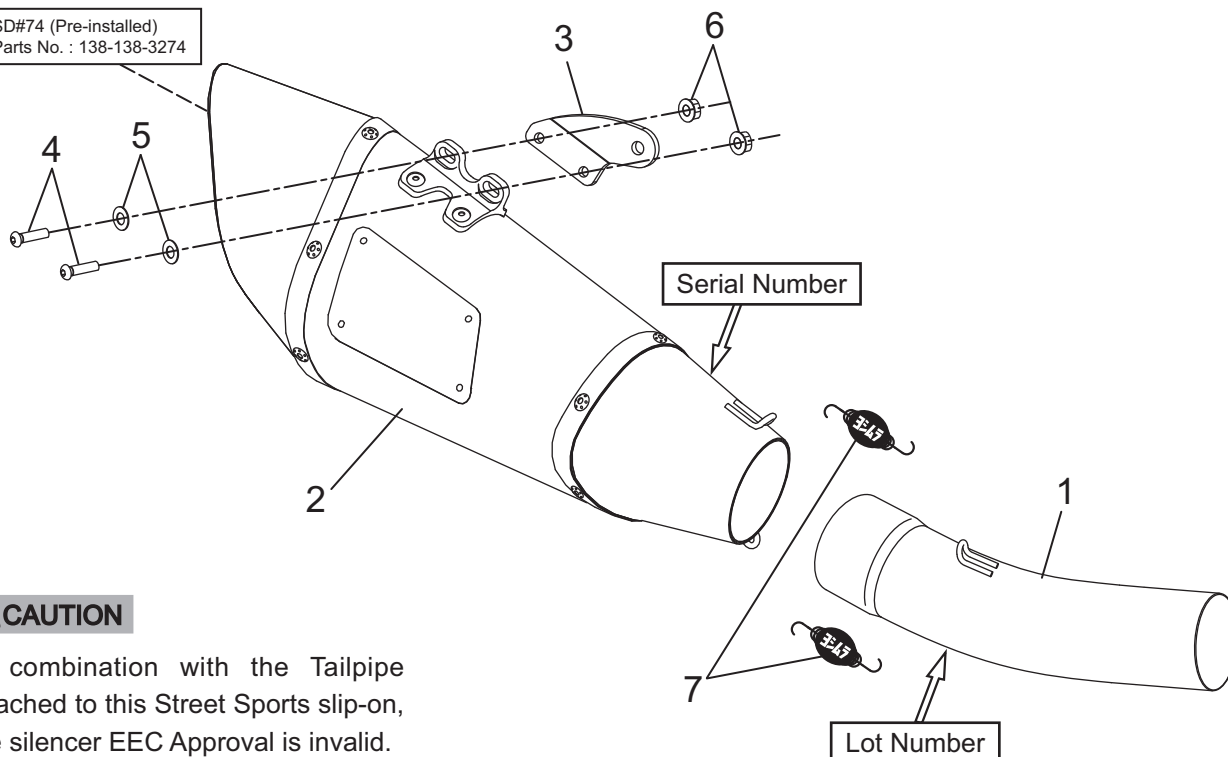

CAUTION

In combination with the Tailpipe attached to this Street Sports slip-on, the silencer EEC Approval is invalid.