

HONDA CBR650R/CB650R STREET SPORTS FULL SYSTEM R-11

Be sure to read the instruction carefully before starting the work. It is necessary to follow the contents to install Yoshimura product.

Product information



- ! CAUTION** Before beginning installation, let motorcycle cool down.
- ! CAUTION** Be sure not to damage each part during installation.
- ! CAUTION** Torque specification must be followed. If neglected, it may cause bolt and nut to fall off and damage to Yoshimura product and motorcycle.
- ! CAUTION** Metal Magic sleeve is coated with heat-resistant paint. Handle with care not to be hit or scratched by surroundings as the coating may come off. When cleaning silencer, use soft cloth with dish soap but do not use metal polish or chemical cleaner.
- ! CAUTION** Titanium Blue sleeve is colored by anodizing. Handle with care as the color may change. When cleaning silencer, use soft cloth with dish soap but do not use metal polish or chemical cleaner.

1. Product Information:

Description	HONDA CBR650R/CB650R Street Sports Full System R-11	Cyclone Type	H46CS11C1
Part Number	Metal Magic Sleeve (SM) : 180-46C-5F20	Main Material	Stainless steel
	Satin Finish Sleeve (SSF) : 180-46C-5F30	Weight	(SMC) & (SSF) : 6.3kg
	Titanium Blue Sleeve (STB) : 180-46C-5F80B	[STD : 8.7kg]	(STB) : 6.1kg

2. Applicable Model :

Model	CBR650R/CB650R(19-20)
-------	-----------------------

3. Contents :

No.	Descriptions	Part No.	Q'ty	No.	Descriptions	Part No.	Q'ty
1	Exhaust Pipe #1	181-46C-5F00	1	9	Cap Bolt M8x25	800-208-5060	2
2	Exhaust Pipe #2	182-46C-5F00	1	10	Cap Bolt M8x35	803-206-4020	1
3	Exhaust Pipe #3	183-46C-5F00	1	11	Washer M8x18	812-108-1820	2
4	Exhaust Pipe #4	184-46C-5F00	1	12	Washer M8x26	812-108-2600	3
5	Exhaust Collector	188-46C-5000	1	13	Flange Nut M8	823-008-1250	1
6	Tailpipe	185-46C-5F00	1	14	Grommet Rubber	553-565-0000	1
7	Silencer Assy Metal Magic Sleeve	186-46C-5F20	1	15	Grommet Spacer	850-208-1212	1
	Silencer Assy Satin Finish Sleeve	186-46C-5F30		16	Exhaust Spring	118-001-2000	6
	Silencer Assy Titanium Blue Sleeve	186-46C-5F80B		17	Exhaust Spring (Short)	118-001-0000	2
8	Silencer Bracket	161-46C-0300	1				

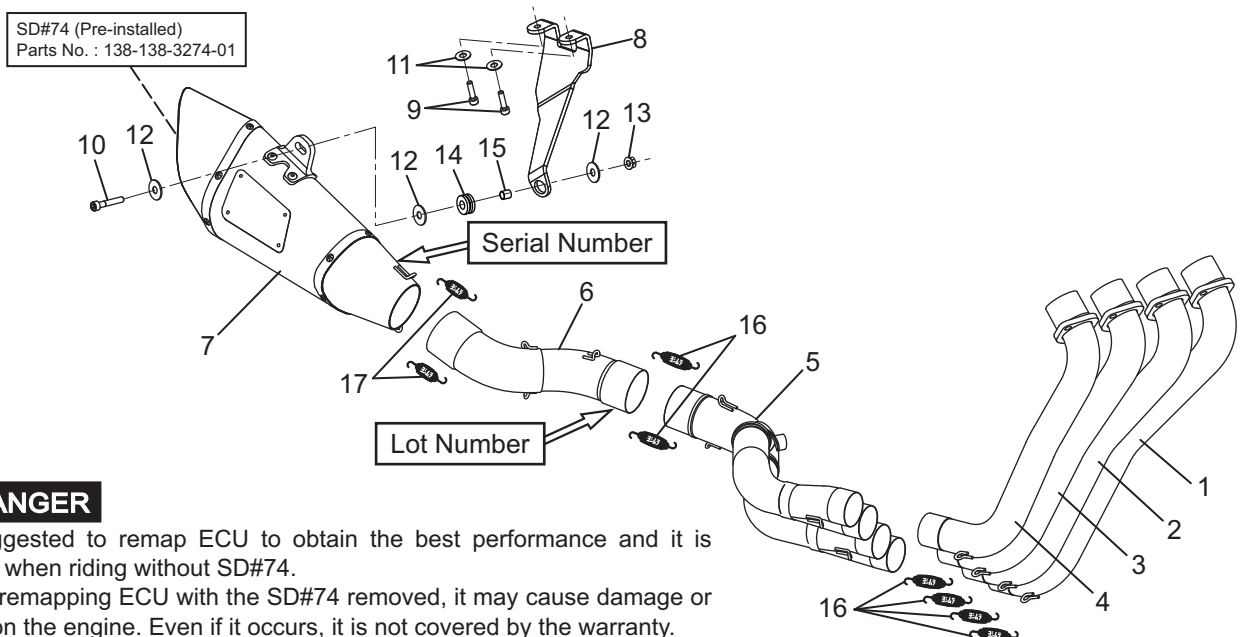

! DANGER

It is suggested to remap ECU to obtain the best performance and it is required when riding without SD#74. Without remapping ECU with the SD#74 removed, it may cause damage or trouble on the engine. Even if it occurs, it is not covered by the warranty.