

SUZUKI GSX-S750 STREET SPORTS FULL SYSTEM R-11Sq

Be sure to read the instruction carefully before starting the work. It is necessary to follow the contents to install Yoshimura product.



- CAUTION** Before beginning installation, let motorcycle cool down.
- CAUTION** Be sure not to damage each part during installation.
- CAUTION** Torque specification must be followed. If neglected, it may cause bolt and nut to fall off and damage to Yoshimura product and motorcycle.
- CAUTION** Metal Magic sleeve is coated with heat-resistant paint. Handle with care not to be hit or scratched by surroundings as the coating may come off. When cleaning silencer, use soft cloth with dish soap but do not use metal polish or chemical cleaner.
- CAUTION** Titanium Blue sleeve is colored by anodizing. Handle with care as the color may change. When cleaning silencer, use soft cloth with dish soap but do not use metal polish or chemical cleaner.

1. Product Information :

Description	SUZUKI GSX-S750 Street Sports Stainless Full System R-11Sq		
Part Number	Metal Magic Sleeve (SM) : 170-150-C12G0	Cyclone Type	S150S1QC2
	Satin Finish Sleeve (SSF) : 170-150-C13G0	Main Material	Stainless steel
	Titanium Blue Sleeve (STB) : 170-150-C16G0	Weight [STD : 10.4kg]	(SS) & (SM) : 6.4kg (STB) : 6.2kg

2. Contents:

No.	Descriptions	Part No.	Q'ty	No.	Descriptions	Part No.	Q'ty
1	Exhaust Pipe #1	171-150-5F00	1	8	Silencer Bracket	161-519-0230	1
2	Exhaust Pipe #2	172-150-5F00	1	9	Button Bolt M6x20	803-206-4020	2
3	Exhaust Pipe #3	173-150-5F00	1	10	Washer M6x13	812-206-1310	2
4	Exhaust Pipe #4	174-150-5F00	1	11	Flange Nut M6	823-006-1000	2
5	Exhaust Collector	119-501-5000	1	12	Exhaust Spring (Short)	118-001-0000	2
6	Tailpipe	175-150-L100	1	13	Exhaust Spring (Long)	118-000-1000	5
7	Silencer Assy, (SM)	1F6-150-L12G0	1	*	Spring Inner Tube	118-000-1100	5
	Silencer Assy, (SSF)	1F6-150-L13G0					
	Silencer Assy, (STB)	1F6-150-L16G0					

3. Optional Part :

Description	Part No.
Carbon Heat Guard Set TYPE-2	161-000-A620

Parts Diagram

SD#105E (Pre-installed)
Parts No. : 138-138-35A5-E4

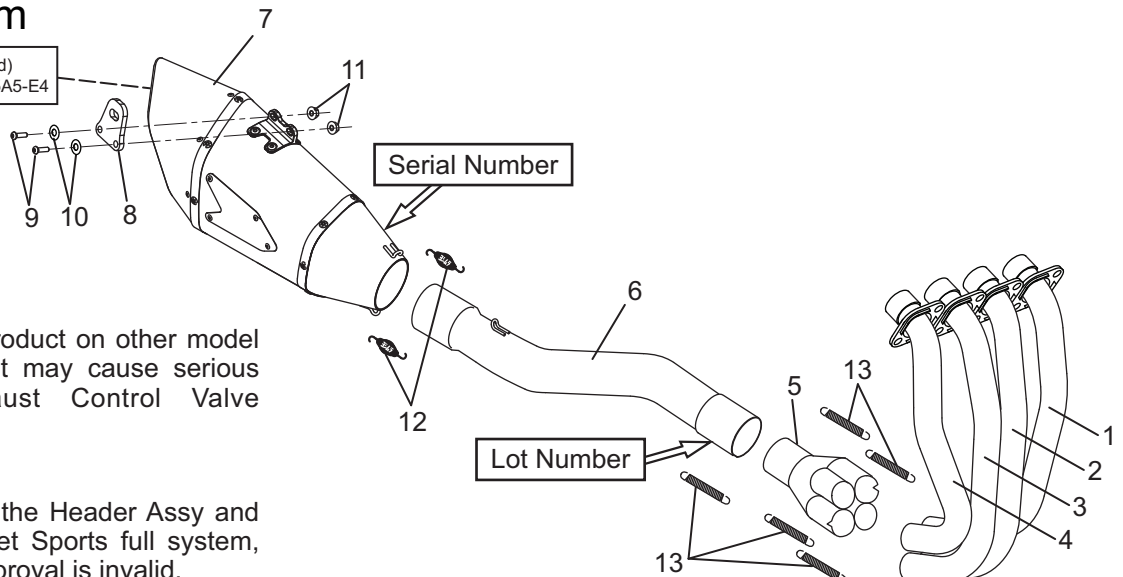

CAUTION
Do not install this product on other model such as GSR750. It may cause serious damage to Exhaust Control Valve Actuator.

CAUTION
In combination with the Header Assy and Tailpipe of this Street Sports full system, the silencer EEC Approval is invalid.