

## SUZUKI GSX-R1000/R L7-M0 EEC Slip-On R-11Sq R

Be sure to read the instruction carefully before starting the work. It is necessary to follow the contents to install Yoshimura product.



- ! CAUTION** Before beginning installation, let motorcycle cool down.
- ! CAUTION** Be sure not to damage each part during installation.
- ! CAUTION** Torque specification must be followed. If neglected, it may cause bolt and nut to fall off and damage to Yoshimura product and motorcycle.
- ! CAUTION** Metal Magic sleeve is coated with heat-resistant paint. Handle with care not to be hit or scratched by surroundings as the coating may come off. When cleaning silencer, use soft cloth with dish soap but do not use metal polish or chemical cleaner.

### 1. Product Information :

Description	SUZUKI GSX-R1000/R L7-M0 EEC Slip-On R-11Sq R	Cyclone Type	S50AS1QC3
Part Number	Metal Magic Sleeve (SM) : 1F0-50A-L12G0	Main Material	Stainless steel
	Satin Finish Sleeve (SSF) : 1F0-50A-L13G0	Weight [STD : 3.8kg]	(SSF) & (SM) : 3.4kg
Homologation / Approved No.	EURO4 / e1 00055G		

### 2. Applicable Model :

Model	SUZUKI GSX-R1000/R L7-L8/L9-M0
-------	--------------------------------

### 3. Contents:

No.	Descriptions	Part No.	Q'ty	No.	Descriptions	Part No.	Q'ty
1	Tailpipe	1F5-50A-L100	1	5	Button Bolt M6x20	803-206-4020	2
2	Silencer Assy Metal Magic Sleeve	1F6-50A-L12G0	1	6	Washer M6x13	812-206-1310	2
	Silencer Assy Satin Finish Sleeve	1F6-50A-L13G0		7	Flange Nut M6	823-006-1000	2
3	Silencer Bracket	161-50A-0260	1	8	Exhaust Spring	118-001-0000	1
4	Washer M8x26	812-108-2600	1	9	Clamp Band	162-02215559	1

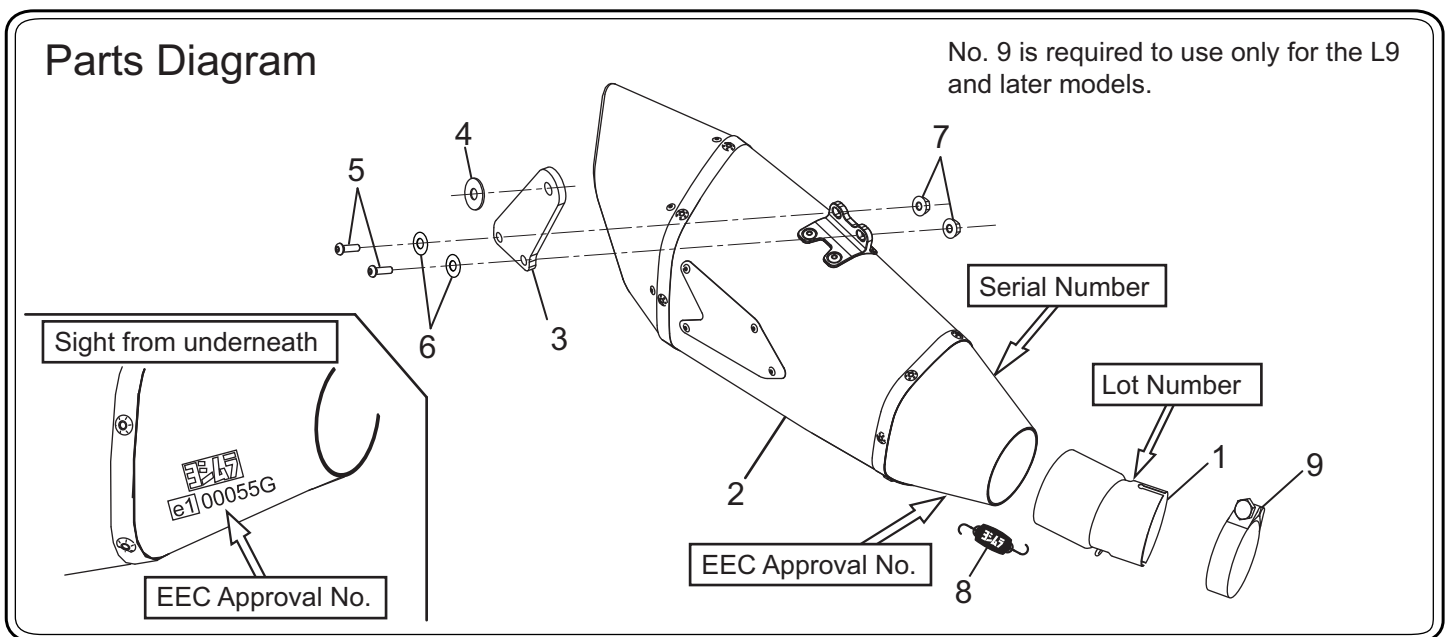

### 4. Optional Part :

Description	Part No.
Silencer Bracket Set	194-50A-0020
Carbon Heat Guard Set	194-50A-0030
Optional Exhaust Pipe for R-11Sq R	194-50A-0040

#### **! CAUTION**

In combination with the EEC Slip-on R-11Sq R and Optional Exhaust Pipe, the silencer EEC Approval is invalid.