

## HONDA GROM / MSX125 STREET SPORTS FULL SYSTEM R-77S

Product information



Be sure to read the instruction carefully before starting the work. It is necessary to follow the contents to install Yoshimura product.

- CAUTION** Before beginning installation, let motorcycle cool down.
- CAUTION** Be sure not to damage each part during installation.
- CAUTION** Torque specification must be followed. If neglected, it may cause bolt and nut to fall off and damage to Yoshimura product and motorcycle.
- CAUTION** Metal Magic sleeve is coated with heat-resistant paint. Handle with care not to be hit or scratched by surroundings as the coating may come off. When cleaning silencer, use soft cloth with dish soap but do not use metal polish or chemical cleaner.
- CAUTION** Titanium Blue sleeve is colored by anodizing. Handle with care as the color may change. When cleaning silencer, use soft cloth with dish soap but do not use metal polish or chemical cleaner.

### 1. Product Information :

Description	HONDA GROM / MSX125 Street Sports Full System R-77S	Cyclone Type	H43GSC11
Part Number	Stainless Sleeve (SM) : 180A-43G-5120	Main Material	Stainless steel
	Metal Magic Sleeve (SSF) : 180A-43G-5130	Weight [STD : 2.8kg]	(SSF) & (SM) : 2.0kg
	Titanium Blue Sleeve (STB) : 180A-43G-5180B		(STB) : 1.8kg

### 2. Applicable Model :

Model	HONDA GROM(21) / MSX125(21)
-------	-----------------------------

### 3. Contents:

No.	Descriptions	Part No.	Q'ty	No.	Descriptions	Part No.	Q'ty
1	Exhaust Pipe	181-43G-5U00	1	5	Cap Bolt M8x20	800-208-5020	1
2	Silencer Assy Metal Magic Sleeve	186-40A-5W21	1	6	Washer M8x20	812-108-2000	1
	Silencer Assy Satin Finish Sleeve	186-40A-5W31		7	Washer M8x25x3.2	812-108-2530	1
	Silencer Assy Titanium Blue Sleeve	186-40A-5W81B		8	Exhaust Spring	118-001-2000	2
3	Silencer Band	162-41R-G501	1	9	SD#98	138-138-4398	1
4	Silencer Band Rubber	896-016-0835	1	10	Cap Bolt M6x6 with thread lock	800-806-4006	1

### Parts Diagram

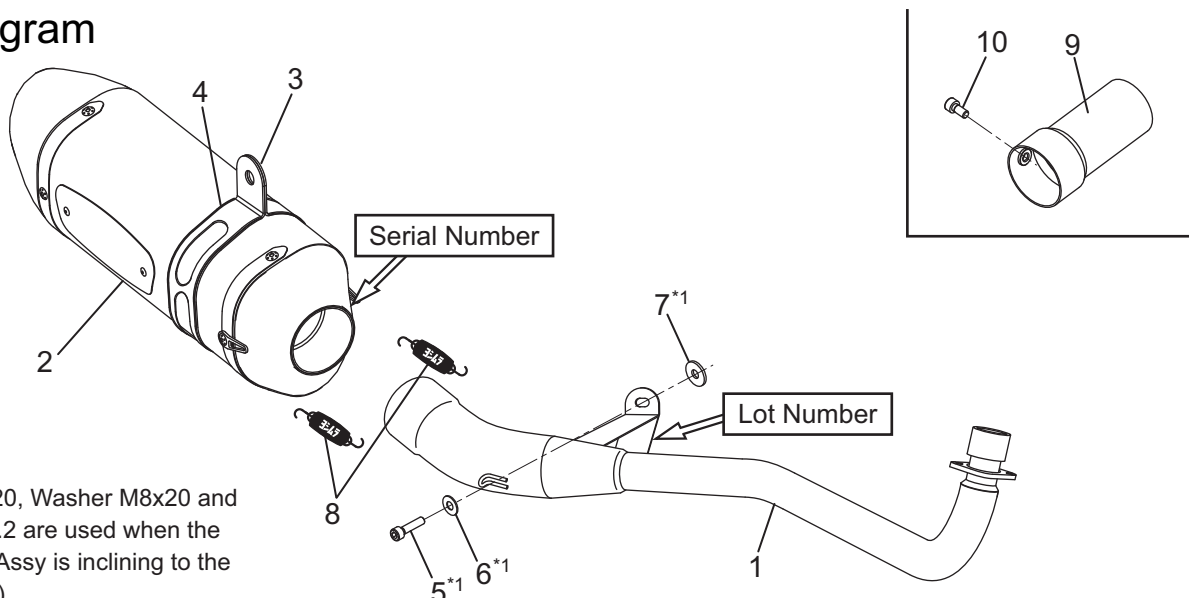

\*1: Cap Bolt M8x20, Washer M8x20 and Washer M8x25x3.2 are used when the angle of Silencer Assy is inclining to the right. (See Step 9)