

## SUZUKI GSX-S750/GSR750 OPTIONAL EXHAUST PIPE FOR R-11

Product information



Be sure to read the instruction carefully before starting the work. It is necessary to follow the contents to install Yoshimura product.

- CAUTION** Before beginning installation, let motorcycle cool down.
- CAUTION** Be sure not to damage each part during installation.
- CAUTION** Torque specification must be followed. If neglected, it may cause bolt and nut to fall off and damage to Yoshimura product and motorcycle.

### 1. Product Information :

Description	SUZUKI GSX-S750/GSR750 Optional Exhaust Pipe for R-11	Cyclone Type	S150S11C1
Part Number	194-150-0010	Main Material	Stainless steel
Note	Exhaust Control Valve Canceller is required for GSR750.	Weight [STD : 4.7kg]	3.9kg

### 2. Applicable Model :

Applicable Model	SUZUKI GSX-S750 / GSR750			
	Yoshimura Slip-On R-11 Single Exit only			
Application	<SUZUKI GSR750/GSX-S750 Street Sports Slip-On R-11 Single Exit> Part number : 170-158-5E**		<SUZUKI GSR750 EEC Slip-On R-11 Single Exit> Part number : 1A0-158-5E**	

### 3. Contents:

No.	Descriptions	Part No.	Q'ty	No.	Descriptions	Part No.	Q'ty
1	Exhaust Pipe #1	171-150-5F00	1	5	Exhaust Collector	119-501-5000	1
2	Exhaust Pipe #2	172-150-5F00	1	6	Tailpipe	175-150-5F00	1
3	Exhaust Pipe #3	173-150-5F00	1	7	Exhaust Spring (Long)	118-000-1000	5
4	Exhaust Pipe #4	174-150-5F00	1	*	Spring Inner Tube	118-000-1100	5

### 4. Optional Part :

Description	Part No.
Carbon Heat Guard Set TYPE-2	161-000-A620

### Parts Diagram

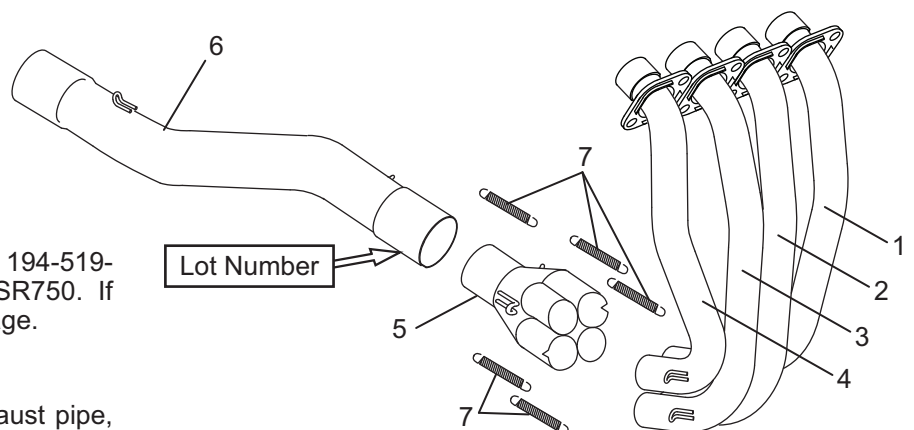

**CAUTION**  
Exhaust Control Valve Canceller (P/N: 194-519-0021) is required when fitting to GSR750. If neglected, it will cause a serious damage.

**CAUTION**  
In combination with this Optional Exhaust pipe, the EEC Approval of Slip-on is invalid.